



Kitchen & Bath 2023 Orderbook





Original Features:

- Simple, Clean Design
- Custom Sizes

Frame Details

- Formed 14ga Steel
- 2.25" Frame Width
- 3/4" - 1.25" Frame Depth (customizable)



original

Frame Styles

Rectangle ✓

Hinge Ratings

1-5 sq/ft	2 hinges
6-10 sq/ft	3 hinges
11-15 sq/ft	4 hinges
16-20 sq/ft	5 hinges

Wood Back-frames

	Door	Drawer
Maple	✓	✓
Knotty Alder	✓	✓
Black Stain	✓	✓
Oak	✓	✓
Cypress	✓	✓
Cellular PVC	✓	✓

Door Styles

Cabinet ✓
Pantry ✓

Additional Options

- Smooth or Hammered rivets
- Top Window



Antique White



Frame Detail



Optional Top Window

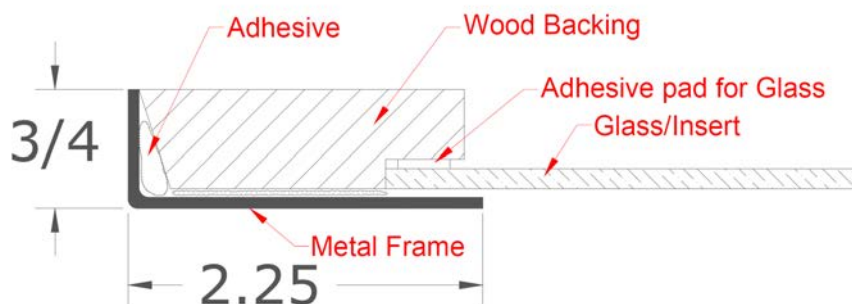

Assembly Detail



Original Cabinet Door

4-6 week production time
Plated finishes 6-8 weeks

Finishes

PowderCoat	Frame	Handle
Aspire Rust	<input type="checkbox"/>	<input type="checkbox"/>
Bronzed Iron	<input type="checkbox"/>	<input type="checkbox"/>
Champagne	<input type="checkbox"/>	<input type="checkbox"/>
Charcoal	<input type="checkbox"/>	<input type="checkbox"/>
Concrete	<input type="checkbox"/>	<input type="checkbox"/>
Copper Vein	<input type="checkbox"/>	<input type="checkbox"/>
Matte Black	<input type="checkbox"/>	<input type="checkbox"/>
Oil Rubbed Bronze	<input type="checkbox"/>	<input type="checkbox"/>
Silver Mist	<input type="checkbox"/>	<input type="checkbox"/>
Silver Vein	<input type="checkbox"/>	<input type="checkbox"/>
Textured Black	<input type="checkbox"/>	<input type="checkbox"/>
Vintage Vein	<input type="checkbox"/>	<input type="checkbox"/>
White	<input type="checkbox"/>	<input type="checkbox"/>
Premium	\$29 sq ft.	\$29 sq ft.
Antique Black	<input type="checkbox"/>	<input type="checkbox"/>
Antique Bronze	<input type="checkbox"/>	<input type="checkbox"/>
Antique Grey	<input type="checkbox"/>	<input type="checkbox"/>
Antique Red	<input type="checkbox"/>	<input type="checkbox"/>
Antique Steel	<input type="checkbox"/>	<input type="checkbox"/>
Brushed Black	<input type="checkbox"/>	<input type="checkbox"/>
Brushed White	<input type="checkbox"/>	<input type="checkbox"/>
Burnished Bronze	<input type="checkbox"/>	<input type="checkbox"/>
Burnished Copper	<input type="checkbox"/>	<input type="checkbox"/>
Hale Navy	<input type="checkbox"/>	<input type="checkbox"/>
Industrial Black	<input type="checkbox"/>	<input type="checkbox"/>
Metallic Latte	<input type="checkbox"/>	<input type="checkbox"/>
Natural Iron	<input type="checkbox"/>	<input type="checkbox"/>
Satin Gold	<input type="checkbox"/>	<input type="checkbox"/>
Solid/Plated	See price guide	See price guide
Brushed Stainless	<input type="checkbox"/>	<input type="checkbox"/>
Polished Stainless	<input type="checkbox"/>	<input type="checkbox"/>
Aged Copper	<input type="checkbox"/>	<input type="checkbox"/>
Aged Brass	<input type="checkbox"/>	<input type="checkbox"/>
Newport Brass	<input type="checkbox"/>	<input type="checkbox"/>
Polished Nickel	<input type="checkbox"/>	<input type="checkbox"/>

Handles	
No Handles	<input type="checkbox"/>
Square	<input type="checkbox"/>
Contemporary	<input type="checkbox"/>
Hampton	<input type="checkbox"/>
Stylus	<input type="checkbox"/> \$75
Minimalist	<input type="checkbox"/> \$75
Designer	<input type="checkbox"/> \$75
Craftsman	<input type="checkbox"/> \$75
Transitional	<input type="checkbox"/> \$75
Industrial	<input type="checkbox"/> \$75

Pricing

formula: base price + sq ft amount above 2 sq ft
example: 5 sq ft: \$328 + (3 sq ft x \$88) = \$592

Door Pricing	Powdercoat	Brushed Stainless	Polished Stainless	Solid/Plated
Base Price up to 2 sq ft	\$328	\$406	Call for quote & availability	
Sq ft Price additional sq ft over 2 sq ft	\$88	\$110		
Premium Finish Upcharge	\$29 per sq ft.	\$29 per sq ft.	N/A	N/A
Drawer Pricing				
Base Price up to 2 sq ft	\$166	\$229	Call for quote & availability	
Sq ft Price additional sq ft over 2 sq ft	\$43	\$65		
Premium Finish Upcharge	\$29 per sq ft.	\$29 per sq ft.	N/A	N/A

Measurements

- _____ A. Finished width of door.
 _____ B. Finished height of door.
 _____ C. Edge of frame to center of hinge hole.
 _____ D. Top edge to center of handle placement.
 _____ E. Overall door thickness. 3/4", 1", or 1.25"
 Hinge left ☐ or Hinge right ☐
 Hinge cutout to fit what style hinge?
 Top Window ☐ \$145
 Slab Door (solid w/o insert) ☐

Wood Back-frames	Door	Drawer
Maple	<input type="checkbox"/>	<input type="checkbox"/>
Alder	<input type="checkbox"/>	<input type="checkbox"/>
Black Stain	<input type="checkbox"/>	<input type="checkbox"/>
Oak	<input type="checkbox"/> \$35	<input type="checkbox"/>
Walnut	<input type="checkbox"/> \$35	<input type="checkbox"/>
Unfinished Wood	<input type="checkbox"/>	<input type="checkbox"/>
Cypress (outdoor)	<input type="checkbox"/> \$35	<input type="checkbox"/>

Glass Inserts	per sq ft
<input type="checkbox"/> Grey <input type="checkbox"/> Clear <input type="checkbox"/> Bronze	N/C
Soft-Etch <input type="checkbox"/> Grey <input type="checkbox"/> Clear <input type="checkbox"/> Bronze	\$160
<input type="checkbox"/> White Linen <input type="checkbox"/> Bronze Linen <input type="checkbox"/> Antique Resin	\$88
Wood Inserts	
<input type="checkbox"/> Engadina <input type="checkbox"/> Espresso <input type="checkbox"/> Salon	N/C
Mesh Inserts	
<input type="checkbox"/> Wire <input type="checkbox"/> Perforated	N/C
<input type="checkbox"/> Decorative	\$127

*Blue selections are the default and will be used if not specified differently

Dealer Information	
Dealer: _____	
Address: _____	
PO#: _____ Name: _____	

Price	
Sub-total	\$
Quantity	x
Total	\$



Designer Features:

- 3/16" Raised Inside Lip
- Custom Sizes

Frame Details

- Formed 14ga Steel
- 2.25" Frame Width
- 3/4" - 1.25" Frame Depth (customizable)
- 3/16" raised inside lip



designer

Frame Styles

Rectangle ✓

Hinge Ratings

1-5 sq/ft	2 hinges
6-10 sq/ft	3 hinges
11-15 sq/ft	4 hinges
16-20 sq/ft	5 hinges

Wood Back-frames

	Door	Drawer
Maple	✓	✓
Knotty Alder	✓	✓
Black Stain	✓	✓
Oak	✓	✓
Cypress	✓	✓
Cellular PVC	✓	✓

Door Styles

Cabinet ✓
Pantry ✓

Additional Options

- Smooth or Hammered rivets
- Top Window



Aged Copper



Frame Detail



Optional Top Window

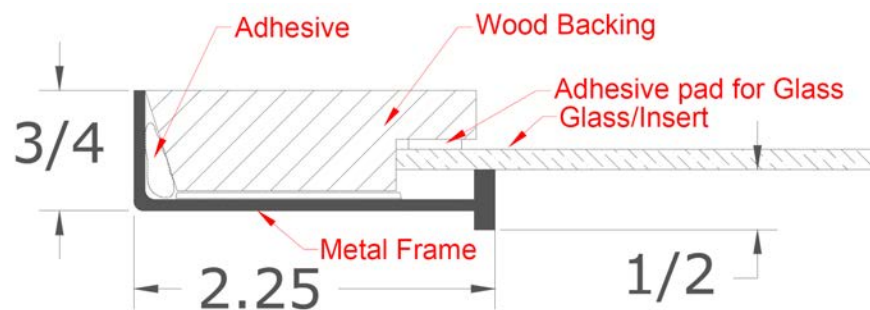

Assembly Detail



Designer Cabinet Door

4-6 week production time
Plated finishes 6-8 weeks

Finishes

PowderCoats	Frame	Handle
Aspire Rust	<input type="checkbox"/>	<input type="checkbox"/>
Bronzed Iron	<input type="checkbox"/>	<input type="checkbox"/>
Champagne	<input type="checkbox"/>	<input type="checkbox"/>
Charcoal	<input type="checkbox"/>	<input type="checkbox"/>
Concrete	<input type="checkbox"/>	<input type="checkbox"/>
Copper Vein	<input type="checkbox"/>	<input type="checkbox"/>
Matte Black	<input type="checkbox"/>	<input type="checkbox"/>
Oil Rubbed Bronze	<input type="checkbox"/>	<input type="checkbox"/>
Silver Mist	<input type="checkbox"/>	<input type="checkbox"/>
Silver Vein	<input type="checkbox"/>	<input type="checkbox"/>
Textured Black	<input type="checkbox"/>	<input type="checkbox"/>
Vintage Vein	<input type="checkbox"/>	<input type="checkbox"/>
White	<input type="checkbox"/>	<input type="checkbox"/>
Premium	\$29 sq ft.	\$29 sq ft.
Antique Bronze	<input type="checkbox"/>	<input type="checkbox"/>
Antique Grey	<input type="checkbox"/>	<input type="checkbox"/>
Antique Red	<input type="checkbox"/>	<input type="checkbox"/>
Brushed Black	<input type="checkbox"/>	<input type="checkbox"/>
Brushed White	<input type="checkbox"/>	<input type="checkbox"/>
Burnished Bronze	<input type="checkbox"/>	<input type="checkbox"/>
Burnished Copper	<input type="checkbox"/>	<input type="checkbox"/>
Hale Navy	<input type="checkbox"/>	<input type="checkbox"/>
Industrial Black	<input type="checkbox"/>	<input type="checkbox"/>
Metallic Latte	<input type="checkbox"/>	<input type="checkbox"/>
Natural Iron	<input type="checkbox"/>	<input type="checkbox"/>
Satin Gold	<input type="checkbox"/>	<input type="checkbox"/>
Solid/Plated	See price guide	See price guide
Aged Copper	<input type="checkbox"/>	<input type="checkbox"/>
Aged Brass	<input type="checkbox"/>	<input type="checkbox"/>

Handles	
No Handles	<input type="checkbox"/>
Square	<input type="checkbox"/>
Contemporary	<input type="checkbox"/>
Hampton	<input type="checkbox"/>
Stylus	<input type="checkbox"/>
Minimalist	<input type="checkbox"/>
Designer	<input type="checkbox"/>
Craftsman	<input type="checkbox"/>
Transitional	<input type="checkbox"/>
Industrial	<input type="checkbox"/>

Wood Back-frames	Door	Drawer
Maple	<input type="checkbox"/>	<input type="checkbox"/>
Alder	<input type="checkbox"/>	<input type="checkbox"/>
Black Stain	<input type="checkbox"/>	<input type="checkbox"/>
Oak	<input type="checkbox"/> \$35	<input type="checkbox"/>
Walnut	<input type="checkbox"/> \$35	<input type="checkbox"/>
Unfinished Wood	<input type="checkbox"/>	<input type="checkbox"/>
Cypress (outdoor)	<input type="checkbox"/> \$35	<input type="checkbox"/>

Glass Inserts	per sq ft
<input type="checkbox"/> Grey <input type="checkbox"/> Clear <input type="checkbox"/> Bronze	N/C
Soft-Etch <input type="checkbox"/> Grey <input type="checkbox"/> Clear <input type="checkbox"/> Bronze	\$160
<input type="checkbox"/> White Linen <input type="checkbox"/> Bronze Linen <input type="checkbox"/> Antique Resin	\$88
Wood Inserts	
<input type="checkbox"/> Engadina <input type="checkbox"/> Espresso <input type="checkbox"/> Salon	N/C
Mesh Inserts	
<input type="checkbox"/> Wire <input type="checkbox"/> Perforated	N/C
<input type="checkbox"/> Decorative	\$127

Pricing

formula: base price + sq ft amount above 2 sq ft
example: 5 sq ft: \$365 + (3 sq ft x \$95) = \$650

Door Pricing	Powdercoat	Solid/Plated
Base Price up to 2 sq ft	\$365	Call for quote & availability
Sq ft Price additional sq ft over 2 sq ft	\$95	
Premium Finish Upcharge	\$29 per sq ft.	N/A
Drawer Pricing		
Base Price up to 2 sq ft	\$212	Call for quote & availability
Sq ft Price additional sq ft over 2 sq ft	\$49	
Premium Finish Upcharge	\$29 per sq ft.	N/A

Measurements

- _____ A. Finished width of door.
 _____ B. Finished height of door.
 _____ C. Edge of frame to center of hinge hole.
 _____ D. Top edge to center of handle placement.
 _____ E. Overall door thickness. 3/4", 1", or 1.25"
 _____ Hinge left ☐ or Hinge right ☐
 _____ Hinge cutout to fit what style hinge?
 _____ Top Window ☐ \$145

*Blue selections are the default and will be used if not specified differently

Dealer Information	
Dealer: _____	
Address: _____	

PO#: _____	Name: _____

Price	
Sub-total	\$
Quantity	x
Total	\$



Transitional Features:

- Raised Outside Lip
- Rustic Rivets
- Custom Sizes

Frame Details

- 1/8" Steel Outside Frame
- 14ga Faceplate w/ Rivets
- 2.25" Frame Width
- 1"-1.25" Frame Depth (customizable)



transitional

Frame Styles

Rectangle ✓

Hinge Ratings

1-5 sq/ft	2 hinges
6-10 sq/ft	3 hinges
11-15 sq/ft	4 hinges
16-20 sq/ft	5 hinges

Wood Back-frames

	Door	Drawer
Maple	✓	✓
Knotty Alder	✓	✓
Black Stain	✓	✓
Oak	✓	✓
Cypress	✓	✓
Cellular PVC	✓	✓

Door Styles

Cabinet ✓
Pantry ✓

Additional Options

- Smooth or Hammered rivets
- Top Window



Drawer Detail



Frame Detail



Optional Top Window

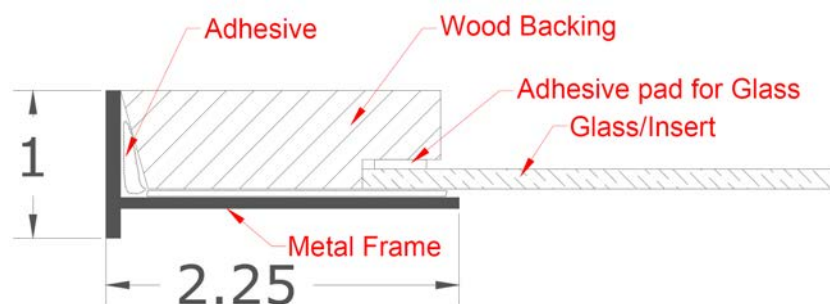

Assembly Detail



Transitional Cabinet Door

4-6 week production time

Finishes

PowderCoats	Frame	Handle
Aspire Rust	<input type="checkbox"/>	<input type="checkbox"/>
Bronzed Iron	<input type="checkbox"/>	<input type="checkbox"/>
Champagne	<input type="checkbox"/>	<input type="checkbox"/>
Charcoal	<input type="checkbox"/>	<input type="checkbox"/>
Concrete	<input type="checkbox"/>	<input type="checkbox"/>
Copper Vein	<input type="checkbox"/>	<input type="checkbox"/>
Matte Black	<input type="checkbox"/>	<input type="checkbox"/>
Oil Rubbed Bronze	<input type="checkbox"/>	<input type="checkbox"/>
Silver Mist	<input type="checkbox"/>	<input type="checkbox"/>
Silver Vein	<input type="checkbox"/>	<input type="checkbox"/>
Textured Black	<input type="checkbox"/>	<input type="checkbox"/>
Vintage Vein	<input type="checkbox"/>	<input type="checkbox"/>
White	<input type="checkbox"/>	<input type="checkbox"/>
Premium	\$29 sq ft.	\$29 sq ft.
Antique Bronze	<input type="checkbox"/>	<input type="checkbox"/>
Antique Grey	<input type="checkbox"/>	<input type="checkbox"/>
Antique Red	<input type="checkbox"/>	<input type="checkbox"/>
Brushed Black	<input type="checkbox"/>	<input type="checkbox"/>
Brushed White	<input type="checkbox"/>	<input type="checkbox"/>
Burnished Bronze	<input type="checkbox"/>	<input type="checkbox"/>
Burnished Copper	<input type="checkbox"/>	<input type="checkbox"/>
Hale Navy	<input type="checkbox"/>	<input type="checkbox"/>
Industrial Black	<input type="checkbox"/>	<input type="checkbox"/>
Metallic Latte	<input type="checkbox"/>	<input type="checkbox"/>
Natural Iron	<input type="checkbox"/>	<input type="checkbox"/>
Satin Gold	<input type="checkbox"/>	<input type="checkbox"/>

Handles	
No Handles	<input type="checkbox"/>
Square	<input type="checkbox"/>
Contemporary	<input type="checkbox"/>
Hampton	<input type="checkbox"/>
Stylus	<input type="checkbox"/>
Minimalist	<input type="checkbox"/>
Designer	<input type="checkbox"/> \$75
Craftsman	<input type="checkbox"/>
Transitional	<input type="checkbox"/>
Industrial	<input type="checkbox"/>

Wood Back-frames	Door	Drawer
Maple	<input type="checkbox"/>	<input type="checkbox"/>
Alder	<input type="checkbox"/>	<input type="checkbox"/>
Black Stain	<input type="checkbox"/>	<input type="checkbox"/>
Oak	<input type="checkbox"/> \$35	<input type="checkbox"/>
Walnut	<input type="checkbox"/> \$35	<input type="checkbox"/>
Unfinished Wood	<input type="checkbox"/>	<input type="checkbox"/>
Cypress (outdoor)	<input type="checkbox"/> \$35	<input type="checkbox"/>

Glass Inserts	per sq ft
<input type="checkbox"/> Grey <input type="checkbox"/> Clear <input type="checkbox"/> Bronze	N/C
Soft-Etch <input type="checkbox"/> Grey <input type="checkbox"/> Clear <input type="checkbox"/> Bronze	\$160
<input type="checkbox"/> White Linen <input type="checkbox"/> Bronze Linen <input type="checkbox"/> Antique Resin	\$88
Wood Inserts	
<input type="checkbox"/> Engadina <input type="checkbox"/> Espresso <input type="checkbox"/> Salon	N/C
Mesh Inserts	
<input type="checkbox"/> Wire <input type="checkbox"/> Perforated	N/C
<input type="checkbox"/> Decorative	\$127

Pricing

formula: base price + sq ft amount above 2 sq ft

example: 5 sq ft: \$380 + (3 sq ft x \$98) = \$674

Door Pricing	Powdercoat
Base Price up to 2 sq ft	\$380
Sq ft Price additional sq ft over 2 sq ft	\$98
Premium Finish Upcharge	\$29 per sq ft.
Drawer Pricing	
Base Price up to 2 sq ft	\$187
Sq ft Price additional sq ft over 2 sq ft	\$55
Premium Finish Upcharge	\$29 per sq ft.

Measurements

- _____ A. Finished width of door.
 _____ B. Finished height of door.
 _____ C. Edge of frame to center of hinge hole.
 _____ D. Top edge to center of handle placement.
 _____ E. Overall door thickness. 1" or 1.25"
 Hinge left ☐ or Hinge right ☐
 Hinge cutout to fit what style hinge?
 _____ Top Window ☐ \$145
 _____ Slab Door (solid w/o insert) ☐

*Blue selections are the default and will be used if not specified differently

Dealer Information	
Dealer: _____	
Address: _____	

PO#: _____	Name: _____

Price	
Sub-total	\$
Quantity	x
Total	\$



Old World Features:

- Decorative Brackets & Rivets
- Custom Sizes

Frame Details

- Formed 14ga Steel
- 2.25" Frame Width
- 3/4" - 1.25" Frame Depth (customizable)



old world

Frame Styles

Rectangle ✓

Hinge Ratings

1-5 sq/ft	2 hinges
6-10 sq/ft	3 hinges
11-15 sq/ft	4 hinges
16-20 sq/ft	5 hinges

Wood Back-frames

	Door	Drawer
Maple	✓	✓
Knotty Alder	✓	✓
Black Stain	✓	✓
Oak	✓	✓
Cypress	✓	✓
Cellular PVC	✓	✓

Door Styles

Cabinet ✓
Pantry ✓

Additional Options

- Smooth or Hammered rivets
- Top Window

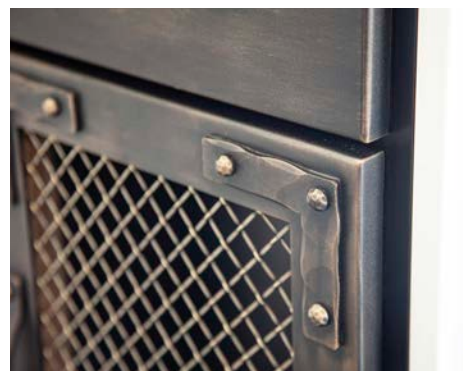

Frame Detail & Decorative Wire



Drawer Detail



Optional Top Window

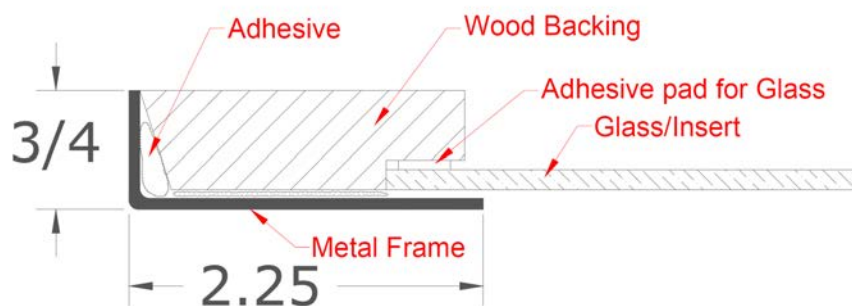

Assembly Detail



Finishes

PowderCoats	Frame	Handle
Aspire Rust	<input type="checkbox"/>	<input type="checkbox"/>
Bronzed Iron	<input type="checkbox"/>	<input type="checkbox"/>
Champagne	<input type="checkbox"/>	<input type="checkbox"/>
Charcoal	<input type="checkbox"/>	<input type="checkbox"/>
Concrete	<input type="checkbox"/>	<input type="checkbox"/>
Copper Vein	<input type="checkbox"/>	<input type="checkbox"/>
Matte Black	<input type="checkbox"/>	<input type="checkbox"/>
Oil Rubbed Bronze	<input type="checkbox"/>	<input type="checkbox"/>
Silver Mist	<input type="checkbox"/>	<input type="checkbox"/>
Silver Vein	<input type="checkbox"/>	<input type="checkbox"/>
Textured Black	<input type="checkbox"/>	<input type="checkbox"/>
Vintage Vein	<input type="checkbox"/>	<input type="checkbox"/>
White	<input type="checkbox"/>	<input type="checkbox"/>
Premium	\$29 sq ft.	\$29 sq ft.
Antique Black	<input type="checkbox"/>	<input type="checkbox"/>
Antique Bronze	<input type="checkbox"/>	<input type="checkbox"/>
Antique Grey	<input type="checkbox"/>	<input type="checkbox"/>
Antique Red	<input type="checkbox"/>	<input type="checkbox"/>
Antique Steel	<input type="checkbox"/>	<input type="checkbox"/>
Brushed Black	<input type="checkbox"/>	<input type="checkbox"/>
Brushed White	<input type="checkbox"/>	<input type="checkbox"/>
Burnished Bronze	<input type="checkbox"/>	<input type="checkbox"/>
Burnished Copper	<input type="checkbox"/>	<input type="checkbox"/>
Hale Navy	<input type="checkbox"/>	<input type="checkbox"/>
Industrial Black	<input type="checkbox"/>	<input type="checkbox"/>
Metallic Latte	<input type="checkbox"/>	<input type="checkbox"/>
Natural Iron	<input type="checkbox"/>	<input type="checkbox"/>
Satin Gold	<input type="checkbox"/>	<input type="checkbox"/>

Handles	
No Handles	<input type="checkbox"/>
Square	<input type="checkbox"/>
Contemporary	<input type="checkbox"/>
Hampton	<input type="checkbox"/>
Stylus	<input type="checkbox"/>
Minimalist	<input type="checkbox"/>
Designer	<input type="checkbox"/> \$75
Craftsman	<input type="checkbox"/>
Transitional	<input type="checkbox"/>
Industrial	<input type="checkbox"/>
Old World	<input type="checkbox"/>

Wood Back-frames	Door	Drawer
Maple	<input type="checkbox"/>	<input type="checkbox"/>
Alder	<input type="checkbox"/>	<input type="checkbox"/>
Black Stain	<input type="checkbox"/>	<input type="checkbox"/>
Oak	<input type="checkbox"/> \$35	<input type="checkbox"/>
Walnut	<input type="checkbox"/> \$35	<input type="checkbox"/>
Unfinished Wood	<input type="checkbox"/>	<input type="checkbox"/>
Cypress (outdoor)	<input type="checkbox"/> \$35	<input type="checkbox"/>

Glass Inserts	per sq ft
<input type="checkbox"/> Grey <input type="checkbox"/> Clear <input type="checkbox"/> Bronze	N/C
Soft-Etch <input type="checkbox"/> Grey <input type="checkbox"/> Clear <input type="checkbox"/> Bronze	\$160
<input type="checkbox"/> White Linen <input type="checkbox"/> Bronze Linen <input type="checkbox"/> Antique Resin	\$88
Wood Inserts	
<input type="checkbox"/> Engadina <input type="checkbox"/> Espresso <input type="checkbox"/> Salon	N/C
Mesh Inserts	
<input type="checkbox"/> Wire <input type="checkbox"/> Perforated	N/C
<input type="checkbox"/> Decorative	\$127

Pricing

formula: base price + sq ft amount above 2 sq ft
 example: 5 sq ft: \$390 + (3 sq ft x \$88) = \$654

Door Pricing	Powdercoat
Base Price up to 2 sq ft	\$390
Sq ft Price additional sq ft over 2 sq ft	\$88
Premium Finish Upcharge	\$29 per sq ft.
Drawer Pricing	
Base Price up to 2 sq ft	\$219
Sq ft Price additional sq ft over 2 sq ft	\$44
Premium Finish Upcharge	\$29 per sq ft.

Measurements

- _____ A. Finished width of door.
 _____ B. Finished height of door.
 _____ C. Edge of frame to center of hinge hole.
 _____ D. Top edge to center of handle placement.
 _____ E. Overall door thickness. 3/4", 1", or 1.25"
 Hinge left ☐ or Hinge right ☐
 Hinge cutout to fit what style hinge?
 _____ Top Window ☐ \$145
 _____ Slab Door (solid w/o insert) ☐

*Blue selections are the default and will be used if not specified differently

Dealer Information	
Dealer: _____	
Address: _____	

PO#: _____	Name: _____

Price	
Sub-total	\$
Quantity	x
Total	\$



Industrial Features:

- Factory Window Pane Design
- Natural Steel Elements
- Custom Sizes

Frame Details

- Formed 14ga Steel
- 2.25" Frame Width
- 3/4" - 1.25" Frame Depth (customizable)



industrial

Frame Styles

Rectangle ✓

Hinge Ratings

1-5 sq/ft	2 hinges
6-10 sq/ft	3 hinges
11-15 sq/ft	4 hinges
16-20 sq/ft	5 hinges

Wood Back-frames

	Door	Drawer
Maple	✓	✓
Knotty Alder	✓	✓
Black Stain	✓	✓
Oak	✓	✓
Cypress	✓	✓
Cellular PVC	✓	✓

Door Styles

Cabinet ✓
Pantry ✓

Additional Options

- Smooth or Hammered rivets
- Top Window

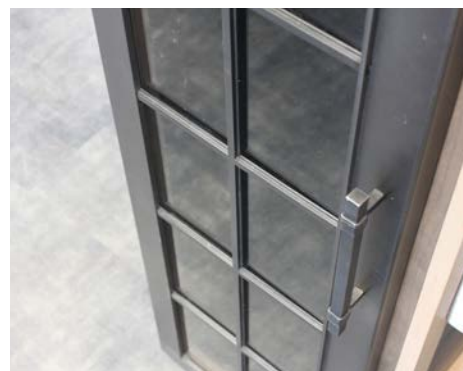

Industrial Black



Frame Detail



Optional Top Window

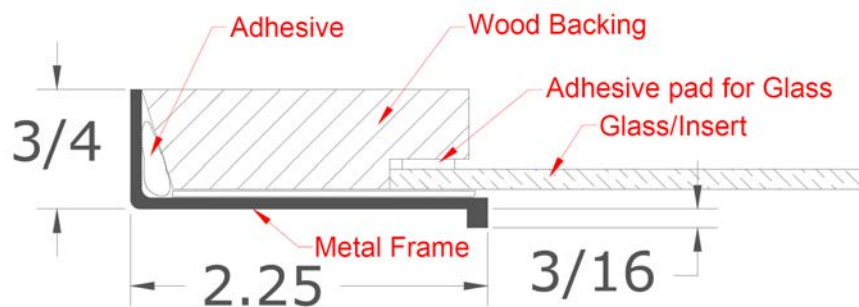

Assembly Detail



Industrial Cabinet Door

4-6 week production time

Finishes

PowderCoats	Frame	Handle
Aspire Rust	<input type="checkbox"/>	<input type="checkbox"/>
Bronzed Iron	<input type="checkbox"/>	<input type="checkbox"/>
Champagne	<input type="checkbox"/>	<input type="checkbox"/>
Charcoal	<input type="checkbox"/>	<input type="checkbox"/>
Concrete	<input type="checkbox"/>	<input type="checkbox"/>
Copper Vein	<input type="checkbox"/>	<input type="checkbox"/>
Matte Black	<input type="checkbox"/>	<input type="checkbox"/>
Oil Rubbed Bronze	<input type="checkbox"/>	<input type="checkbox"/>
Silver Mist	<input type="checkbox"/>	<input type="checkbox"/>
Silver Vein	<input type="checkbox"/>	<input type="checkbox"/>
Textured Black	<input type="checkbox"/>	<input type="checkbox"/>
Vintage Vein	<input type="checkbox"/>	<input type="checkbox"/>
White	<input type="checkbox"/>	<input type="checkbox"/>
Premium	\$29 sq ft.	\$29 sq ft.
Antique Bronze	<input type="checkbox"/>	<input type="checkbox"/>
Antique Grey	<input type="checkbox"/>	<input type="checkbox"/>
Antique Red	<input type="checkbox"/>	<input type="checkbox"/>
Brushed Black	<input type="checkbox"/>	<input type="checkbox"/>
Brushed White	<input type="checkbox"/>	<input type="checkbox"/>
Burnished Bronze	<input type="checkbox"/>	<input type="checkbox"/>
Burnished Copper	<input type="checkbox"/>	<input type="checkbox"/>
Hale Navy	<input type="checkbox"/>	<input type="checkbox"/>
Industrial Black	<input type="checkbox"/>	<input type="checkbox"/>
Metallic Latte	<input type="checkbox"/>	<input type="checkbox"/>
Natural Iron	<input type="checkbox"/>	<input type="checkbox"/>
Satin Gold	<input type="checkbox"/>	<input type="checkbox"/>

Handles	
No Handles	<input type="checkbox"/>
Square	<input type="checkbox"/>
Contemporary	<input type="checkbox"/>
Hampton	<input type="checkbox"/>
Stylus	<input type="checkbox"/>
Minimalist	<input type="checkbox"/>
Designer	<input type="checkbox"/> \$75
Craftsman	<input type="checkbox"/>
Transitional	<input type="checkbox"/>
Industrial	<input type="checkbox"/>

Wood Back-frames	Door	Drawer
Maple	<input type="checkbox"/>	<input type="checkbox"/>
Alder	<input type="checkbox"/>	<input type="checkbox"/>
Black Stain	<input type="checkbox"/>	<input type="checkbox"/>
Oak	<input type="checkbox"/> \$35	<input type="checkbox"/>
Walnut	<input type="checkbox"/> \$35	<input type="checkbox"/>
Unfinished Wood	<input type="checkbox"/>	<input type="checkbox"/>
Cypress (outdoor)	<input type="checkbox"/> \$35	<input type="checkbox"/>

Glass Inserts	per sq ft
<input type="checkbox"/> Grey <input type="checkbox"/> Clear <input type="checkbox"/> Bronze	N/C
Soft-Etch <input type="checkbox"/> Grey <input type="checkbox"/> Clear <input type="checkbox"/> Bronze	\$160
<input type="checkbox"/> White Linen <input type="checkbox"/> Bronze Linen <input type="checkbox"/> Antique Resin	\$88
Wood Inserts	
<input type="checkbox"/> Engadina <input type="checkbox"/> Espresso <input type="checkbox"/> Salon	N/C
Mesh Inserts	
<input type="checkbox"/> Wire <input type="checkbox"/> Perforated	N/C
<input type="checkbox"/> Decorative	\$127

Pricing

formula: base price + sq ft amount above 2 sq ft
example: 5 sq ft: \$391 + (3 sq ft x \$106) = \$709

Door Pricing	Powdercoat
Base Price up to 2 sq ft	\$391
Sq ft Price additional sq ft over 2 sq ft	\$106
Premium Finish Upcharge	\$29 per sq ft.
Drawer Pricing	
Base Price up to 2 sq ft	\$218
Sq ft Price additional sq ft over 2 sq ft	\$46
Premium Finish Upcharge	\$29 per sq ft.

Measurements

- _____ A. Finished width of door.
 _____ B. Finished height of door.
 _____ C. Edge of frame to center of hinge hole.
 _____ D. Top edge to center of handle placement.
 _____ E. Overall door thickness. 3/4", 1", or 1.25"
 Hinge left ☐ or Hinge right ☐
 _____ Hinge cutout to fit what style hinge?
 _____ Top Window ☐ \$145

*Blue selections are the default and will be used if not specified differently

Dealer Information	
Dealer: _____	
Address: _____	

PO#: _____	Name: _____

Price	
Sub-total	\$
Quantity	x
Total	\$



Modern Features:

- 1" x 3/16" Raised Frame Ring & Modern Rivets
- Custom Sizes

Frame Details

- Formed 14ga Steel
- 2.25" Frame Width
- 3/4" - 1.25" Frame Depth (customizable)



modern

Frame Styles

Rectangle ✓

Hinge Ratings

1-5 sq/ft	2 hinges
6-10 sq/ft	3 hinges
11-15 sq/ft	4 hinges
16-20 sq/ft	5 hinges

Wood Back-frames

	Door	Drawer
Maple	✓	✓
Knotty Alder	✓	✓
Black Stain	✓	✓
Oak	✓	✓
Cypress	✓	✓
Cellular PVC	✓	✓

Door Styles

Cabinet ✓
Pantry ✓

Additional Options

- Modern Rivets
- Top Window



Brushed & Polished Nickel



Optional Top Window



Frame Detail

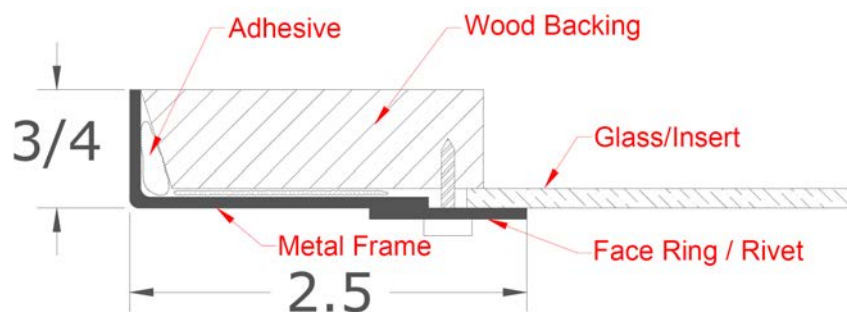

Assembly Detail



Modern Cabinet Door

4-6 week production time
Plated finishes 6-8 weeks

Finishes

PowderCoats	Frame	Handle
Aspire Rust	<input type="checkbox"/>	<input type="checkbox"/>
Bronzed Iron	<input type="checkbox"/>	<input type="checkbox"/>
Champagne	<input type="checkbox"/>	<input type="checkbox"/>
Charcoal	<input type="checkbox"/>	<input type="checkbox"/>
Concrete	<input type="checkbox"/>	<input type="checkbox"/>
Copper Vein	<input type="checkbox"/>	<input type="checkbox"/>
Matte Black	<input type="checkbox"/>	<input type="checkbox"/>
Oil Rubbed Bronze	<input type="checkbox"/>	<input type="checkbox"/>
Silver Mist	<input type="checkbox"/>	<input type="checkbox"/>
Silver Vein	<input type="checkbox"/>	<input type="checkbox"/>
Textured Black	<input type="checkbox"/>	<input type="checkbox"/>
Vintage Vein	<input type="checkbox"/>	<input type="checkbox"/>
White	<input type="checkbox"/>	<input type="checkbox"/>
Premium	\$29 sq ft.	\$29 sq ft.
Antique Black	<input type="checkbox"/>	<input type="checkbox"/>
Antique Bronze	<input type="checkbox"/>	<input type="checkbox"/>
Antique Grey	<input type="checkbox"/>	<input type="checkbox"/>
Antique Red	<input type="checkbox"/>	<input type="checkbox"/>
Antique Steel	<input type="checkbox"/>	<input type="checkbox"/>
Brushed Black	<input type="checkbox"/>	<input type="checkbox"/>
Brushed White	<input type="checkbox"/>	<input type="checkbox"/>
Burnished Bronze	<input type="checkbox"/>	<input type="checkbox"/>
Burnished Copper	<input type="checkbox"/>	<input type="checkbox"/>
Hale Navy	<input type="checkbox"/>	<input type="checkbox"/>
Industrial Black	<input type="checkbox"/>	<input type="checkbox"/>
Metallic Latte	<input type="checkbox"/>	<input type="checkbox"/>
Natural Iron	<input type="checkbox"/>	<input type="checkbox"/>
Satin Gold	<input type="checkbox"/>	<input type="checkbox"/>
Solid/Plated	See price guide	See price guide
Brushed Stainless	<input type="checkbox"/>	<input type="checkbox"/>
Polished Stainless	<input type="checkbox"/>	<input type="checkbox"/>
Aged Copper	<input type="checkbox"/>	<input type="checkbox"/>
Aged Brass	<input type="checkbox"/>	<input type="checkbox"/>
Newport Brass	<input type="checkbox"/>	<input type="checkbox"/>
Polished Nickel	<input type="checkbox"/>	<input type="checkbox"/>

Handles	
No Handles	<input type="checkbox"/>
Square	<input type="checkbox"/>
Contemporary	<input type="checkbox"/>
Hampton	<input type="checkbox"/>
Stylus	<input type="checkbox"/>
Minimalist	<input type="checkbox"/>
Designer	<input type="checkbox"/>
Craftsman	<input type="checkbox"/>
Transitional	<input type="checkbox"/>
Industrial	<input type="checkbox"/>

Pricing

formula: base price + sq ft amount above 2 sq ft
example: 5 sq ft: \$456 + (3 sq ft x \$109) = \$783

Door Pricing	Powdercoat	Brushed Stainless	Polished Stainless	Solid/Plated
Base Price up to 2 sq ft	\$456	\$573	Call for quote & availability	
Sq ft Price additional sq ft over 2 sq ft	\$109	\$157		
Premium Finish Upcharge	\$29 per sq ft.	\$29 per sq ft.	N/A	N/A
Drawer Pricing				
Base Price up to 2 sq ft	\$228	\$305	Call for quote & availability	
Sq ft Price additional sq ft over 2 sq ft	\$65	\$113		
Premium Finish Upcharge	\$29 per sq ft.	\$29 per sq ft.	N/A	N/A

Measurements

- _____ A. Finished width of door.
 _____ B. Finished height of door.
 _____ C. Edge of frame to center of hinge hole.
 _____ D. Top edge to center of handle placement.
 _____ E. Overall door thickness. 3/4", 1", or 1.25"
 Hinge left ☐ or Hinge right ☐
 Hinge cutout to fit what style hinge?
 _____ Top Window ☐ \$145
 _____ Slab Door (solid w/o insert) ☐

Wood Back-frames	Door	Drawer
Maple	<input type="checkbox"/>	<input type="checkbox"/>
Alder	<input type="checkbox"/>	<input type="checkbox"/>
Black Stain	<input type="checkbox"/>	<input type="checkbox"/>
Oak	<input type="checkbox"/> \$35	<input type="checkbox"/>
Walnut	<input type="checkbox"/> \$35	<input type="checkbox"/>
Unfinished Wood	<input type="checkbox"/>	<input type="checkbox"/>
Cypress (outdoor)	<input type="checkbox"/> \$35	<input type="checkbox"/>

Glass Inserts	per sq ft
<input type="checkbox"/> Grey <input type="checkbox"/> Clear <input type="checkbox"/> Bronze	N/C
Soft-Etch <input type="checkbox"/> Grey <input type="checkbox"/> Clear <input type="checkbox"/> Bronze	\$160
<input type="checkbox"/> White Linen <input type="checkbox"/> Bronze Linen <input type="checkbox"/> Antique Resin	\$88
Wood Inserts	
<input type="checkbox"/> Engadina <input type="checkbox"/> Espresso <input type="checkbox"/> Salon	N/C
Mesh Inserts	
<input type="checkbox"/> Wire <input type="checkbox"/> Perforated	N/C
<input type="checkbox"/> Decorative	\$127

*Blue selections are the default and will be used if not specified differently

Dealer Information	
Dealer: _____	
Address: _____	

PO#: _____	Name: _____

Price	
Sub-total	\$
Quantity	x
Total	\$



Aluminum Door Features:

- Classic Design that blends with any style
- Custom Sizes



tribeca



nolita

Frame Details

- Aluminum Frame
- 2 different Frame profiles

Frame Styles

Rectangle



Hinge Ratings

1-5 sq/ft	2 hinges
6-10 sq/ft	3 hinges
11-15 sq/ft	4 hinges
16-20 sq/ft	5 hinges

Door Styles

Cabinet



Pantry



Tribeca Frame

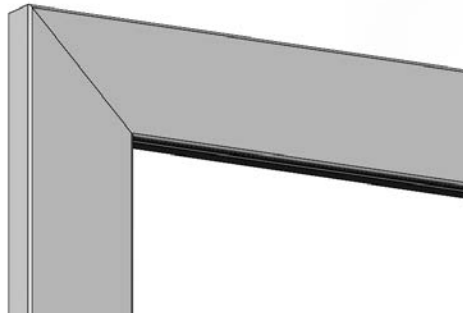

Frame Profile



Frame Detail

Nolita Frame

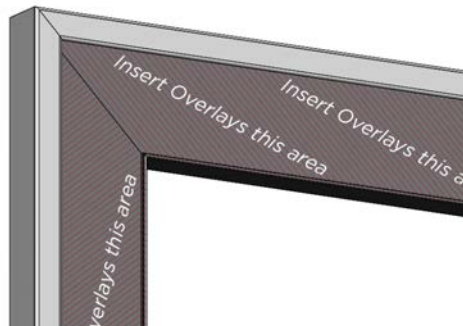

Frame Profile



Frame Detail



Aluminum Cabinet Doors

4-6 week production time

Pricing

formula: base price + sq ft amount above 2 sq ft
example: 5 sq ft: \$332 + (3 sq ft x \$106) = \$650

Frame Style	
Tribeca	<input type="checkbox"/>
Nolita	<input type="checkbox"/>

Finishes

PowderCoat	Frame	Handle
Aspire Rust	<input type="checkbox"/>	<input type="checkbox"/>
Bronzed Iron	<input type="checkbox"/>	<input type="checkbox"/>
Champagne	<input type="checkbox"/>	<input type="checkbox"/>
Charcoal	<input type="checkbox"/>	<input type="checkbox"/>
Concrete	<input type="checkbox"/>	<input type="checkbox"/>
Copper Vein	<input type="checkbox"/>	<input type="checkbox"/>
Matte Black	<input type="checkbox"/>	<input type="checkbox"/>
Oil Rubbed Bronze	<input type="checkbox"/>	<input type="checkbox"/>
Silver Mist	<input type="checkbox"/>	<input type="checkbox"/>
Silver Vein	<input type="checkbox"/>	<input type="checkbox"/>
Textured Black	<input type="checkbox"/>	<input type="checkbox"/>
Vintage Vein	<input type="checkbox"/>	<input type="checkbox"/>
White	<input type="checkbox"/>	<input type="checkbox"/>
Premium	\$29 sq ft.	\$29 sq ft.
Antique Bronze	<input type="checkbox"/>	<input type="checkbox"/>
Antique Grey	<input type="checkbox"/>	<input type="checkbox"/>
Antique Red	<input type="checkbox"/>	<input type="checkbox"/>
Brushed Black	<input type="checkbox"/>	<input type="checkbox"/>
Brushed White	<input type="checkbox"/>	<input type="checkbox"/>
Burnished Bronze	<input type="checkbox"/>	<input type="checkbox"/>
Burnished Copper	<input type="checkbox"/>	<input type="checkbox"/>
Hale Navy	<input type="checkbox"/>	<input type="checkbox"/>
Metallic Latte	<input type="checkbox"/>	<input type="checkbox"/>
Natural Iron	<input type="checkbox"/>	<input type="checkbox"/>
Satin Gold	<input type="checkbox"/>	<input type="checkbox"/>

Door Pricing	Powdercoat
Base Price up to 2 sq ft	\$332
Sq ft Price additional sq ft over 2 sq ft	\$106
Premium Finish Upcharge	\$29 per sq ft.
Drawer Pricing	
Base Price up to 2 sq ft	\$166
Sq ft Price additional sq ft over 2 sq ft	\$432
Premium Finish Upcharge	\$29 per sq ft.

Measurements

- _____ A. Finished width of door.
 _____ B. Finished height of door.
 _____ C. Edge of frame to center of hinge hole.
 _____ D. Top edge to center of handle placement.
 _____ Hinge cutout to fit what style hinge?

Glass Inserts	per sq ft
<input type="checkbox"/> Grey <input type="checkbox"/> Clear <input type="checkbox"/> Bronze	N/C
Soft-Etch <input type="checkbox"/> Grey <input type="checkbox"/> Clear <input type="checkbox"/> Bronze	\$160
<input type="checkbox"/> White Linen <input type="checkbox"/> Bronze Linen <input type="checkbox"/> Antique Resin	\$88
Wood Inserts	
<input type="checkbox"/> Engadina <input type="checkbox"/> Espresso <input type="checkbox"/> Salon	N/C
Mesh Inserts	
<input type="checkbox"/> Wire <input type="checkbox"/> Perforated	N/C
<input type="checkbox"/> Decorative	\$127

*Blue selections are the default and will be used if not specified differently

Dealer Information	
Dealer: _____	
Address: _____	

PO #: _____	Name: _____

Price	
Sub-total	\$
Quantity	x
Total	\$



Metal & Glass Cabinet

- Simple, Clean Design
- No additional wooden cabinetry needed
- Standard & Custom Sizes
- Includes Glass Shelves

Details

- 11 ga Steel Doors
- 14 ga Steel Frame
- 1.25" Frame Width
- Clear Glass



metal & glass cabinets

Max Dimensions

Up to 33" w: 96" h x 12" d

Up to 48" w: 58" h x 15" d



Cabinet Detail



Metal & Glass Cabinets

4-6 week production time

Finishes	
PowderCoat	
Aspire Rust	<input type="checkbox"/>
Bronzed Iron	<input type="checkbox"/>
Champagne	<input type="checkbox"/>
Charcoal	<input type="checkbox"/>
Concrete	<input type="checkbox"/>
Copper Vein	<input type="checkbox"/>
Matte Black	<input type="checkbox"/>
Oil Rubbed Bronze	<input type="checkbox"/>
Silver Mist	<input type="checkbox"/>
Silver Vein	<input type="checkbox"/>
Textured Black	<input type="checkbox"/>
Vintage Vein	<input type="checkbox"/>
White	<input type="checkbox"/>
Premium	
Burnished Bronze	<input type="checkbox"/> \$185
Burnished Copper	<input type="checkbox"/> \$185
Hale Navy	<input type="checkbox"/> \$185
Metallic Latte	<input type="checkbox"/> \$185
Natural Iron	<input type="checkbox"/> \$185
Satin Gold	<input type="checkbox"/> \$185

Standard Sizes	
<i>All standard sizes are 12" deep</i>	
Size	Powdercoat
<input type="checkbox"/> 16w x 36h	\$1750
<input type="checkbox"/> 16w x 42h	\$1750
<input type="checkbox"/> 30w x 36h	\$2050
<input type="checkbox"/> 30w x 42h	\$2250
<input type="checkbox"/> 36w x 36h	\$2250
<input type="checkbox"/> 36w x 42h	\$2450

Custom Pricing	
Formula: base price + sq ft amount above 6 sq ft example: 8 sq ft: \$1950 + (2 sq ft x \$125) = \$2,200	
Pricing	Powdercoat
Base Price <i>up to 6 sq ft</i>	\$1950
Sq ft Price <i>additional sq ft over 6 sq ft</i>	\$125
Premium Finish Upcharge	\$185
Custom Sizes	
Finished Width of Cabinet: _____ Finished Height of Cabinet: _____ Finished Depth of Cabinet: <input type="checkbox"/> 12" <input type="checkbox"/> 15"	
Door Style	
<input type="checkbox"/> Double Door <input type="checkbox"/> Single Door Hinge Left <input type="checkbox"/> Single Door Hinge Right	
Options	
<input type="checkbox"/> LED Lights \$185 <input type="checkbox"/> Knob Handle <input type="checkbox"/> No Handle	

*Blue selections are the default and will be used if not specified differently

Dealer Information	
Dealer: _____	
Address: _____	

PO#: _____	Name: _____

Price	
Sub-total	\$
Quantity	x
Total	\$

INSERTS AND GLASS OPTIONS



Clear



Grey



Bronze



Clear SoftEtch



Grey SoftEtch



Bronze SoftEtch



White Linen



Bronze Linen



Antique Resin



Wire Mesh

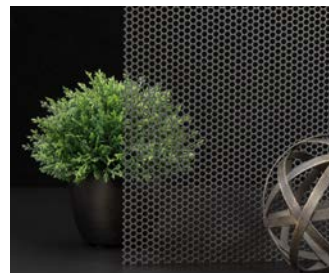

Perforated Mesh

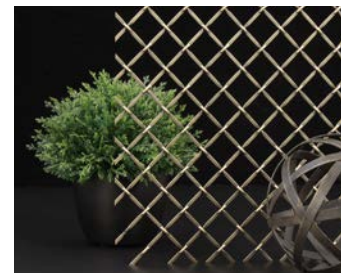

Decorative Wire



Engadina



Espresso



Salon

HANDLES

See order forms for pricing



Old World



Craftsman



Transitional



Industrial



Contemporary



Designer



Square



Hampton



Stylus



Minimalist

WOODEN BACKFRAMES



MAPLE



ALDER



BLACK STAIN
*DOOR DEFAULT FRAME



OAK
*DRAWER DEFAULT FRAME



WALNUT



CYPRESS *OUTDOOR

UNFINISHED WOOD

IF A CUSTOMER WOULD LIKE TO USE THEIR OWN STAIN OR PAINT, THEY MAY CHOOSE THIS OPTION.

RANGE HOOD ACCENTS & OPTIONS



Stacked

- Only available on the ST1100



Transitional

- Available on the ST1200 & ST1300
- Not available in Stainless or Solid Finishes



Crown Molding

- Extruded Aluminum Material
- Not available in Stainless or Solid Finishes



Embossed (angled)

- Available on top or bottom



Embossed (square)

- Available on top or bottom

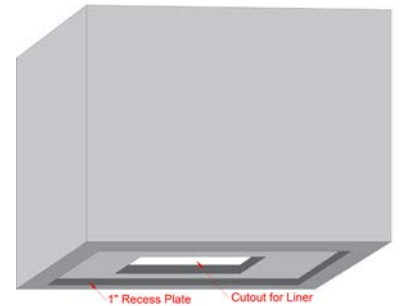

Recessed Liner

- Decorative option for liner placement
- May limit Liner options



Hidden Access Panel

- Provides access for cleaning or inspection



RANGE HOOD FINISH AVAILABILITY

Range Hood Finish Availability									Banding	
Finishes	Style Body					Stacked	Transitional		Vertical	Horizontal
	ST1100	ST1200	ST1300	ST1400	ST1500	ST1100	ST1200	ST1300		
Powdercoat										
	Available in all Powdercoat Finishes								Available in all Powdercoat Finishes	
Premium										
Antique Black *	✓	✓	✓	✓	✓	✓	✓	N/A	✓	✓
Antique Bronze *	✓	✓	✓	✓	✓	✓	✓	✓	✓	✓
Antique Grey *	✓	✓	✓	✓	✓	✓	✓	✓	✓	✓
Antique Red *	✓	✓	✓	✓	✓	✓	✓	✓	✓	✓
Antique Steel *	✓	✓	✓	✓	✓	✓	✓	N/A	✓	✓
Brushed Black *	✓	✓	✓	✓	✓	✓	✓	✓	✓	✓
Brushed White *	✓	✓	✓	✓	✓	✓	✓	✓	✓	✓
Burnished Bronze *	✓	✓	✓	✓	✓	✓	✓	✓	✓	✓
Burnished Copper *	✓	✓	✓	✓	✓	✓	✓	✓	✓	✓
Hale Navy	✓	✓	✓	✓	✓	✓	✓	✓	✓	✓
Industrial Black	✓	✓	✓	✓	✓	✓	✓	✓	✓	✓
Metallic Latte	✓	✓	✓	✓	✓	✓	✓	✓	✓	✓
Natural Iron	✓	✓	✓	✓	✓	✓	✓	✓	✓	✓
Satin Gold	✓	✓	✓	✓	✓	✓	✓	✓	✓	✓
Solid										
Brushed Stainless	✓	✓	✓	✓	✓	✓	N/A	N/A	✓	✓
Aged Copper *	✓	✓	N/A	✓	✓	*	N/A	N/A	✓	*
Aged Brass *	✓	✓	N/A	✓	✓	*	N/A	N/A	✓	*
Newport Brass *	✓	✓	N/A	✓	✓	*	N/A	N/A	✓	*
*Size limitations exist and may cause butt jointed seams or horizontal seams going up the hood due to material sheet size, or human inability to brush straight. Hoods above 50" high with brushed finishes will require a horizontal seam.										
Hoods/Accent Kits that have brushed finishes may need to be bolted together at areas with tight corner transitions in order to accomplish a full brushed finish to the area.										

Accents			
	Powdercoats	Premium	Solid
Stacked	All Finishes	All Finishes	All Finishes, with sizing limitations
Transitional	All Finishes	All Finishes except for ST1300, see chart above	N/A
Embossed (Square)	All Finishes	All Finishes	N/A
Embossed (Angled)	All Finishes	All Finishes	N/A
Crown Molding	All Finishes	Burnished Bronze, Burnished Copper, Hale Navy, Metallic Latte, Natural Iron, Satin Gold	N/A
Banding	All Finishes	All Finishes	All Finishes
Rustic Rivets	All Finishes	All except Antique Black & Antique Steel	N/A
Modern Rivets	All Finishes	All Finishes	All except Aged Copper



Range Hood | Standard Sizes

4-6 week production time

ST1110S



*Includes choice of banding color

Pricing		
Size	Standard	Premium
<input type="checkbox"/> 36w x 22d x ____h	\$2645	\$3219
<input type="checkbox"/> 42w x 22d x ____h	\$3004	\$3724
<input type="checkbox"/> 48w x 22d x ____h	\$3004	\$3724
<input type="checkbox"/> 54w x 22d x ____h	\$3004	\$3724
Height Upcharge		
Up to 40"	40" - 60"	60" - 80"
No Charge	+ \$580	+ \$920

Finishes	
	Write Desired Finish Below
Base	
Banding	
Please see page 21 for available finishes	
Liner	
Hood Liner (fan) provided by Customer Please provide make, model & spec sheet	<input type="checkbox"/>
Hood Liner (fan) provided by Stoll Please contact Stoll for custom quote	<input type="checkbox"/>

ST1310S



*Includes Banding, Rustic Rivets, & Transitional Accents as shown

Pricing		
Size	Standard	Premium
<input type="checkbox"/> 36w x 22d x ____h	\$3774	\$4351
<input type="checkbox"/> 42w x 22d x ____h	\$4375	\$5092
<input type="checkbox"/> 48w x 22d x ____h	\$4375	\$5092
<input type="checkbox"/> 54w x 22d x ____h	\$4375	\$5092
Height Upcharge		
Up to 40"	40" - 60"	60" - 80"
No Charge	+ \$580	+ \$920

Finishes	
	Write Desired Finish Below
Base	
Banding	
Please see page 21 for available finishes	
Liner	
Hood Liner (fan) provided by Customer Please provide make, model & spec sheet	<input type="checkbox"/>
Hood Liner (fan) provided by Stoll Please contact Stoll for custom quote	<input type="checkbox"/>

ST1320S



*Includes Banding as shown

Pricing		
Size	Standard	Premium
<input type="checkbox"/> 36w x 22d x ____h	\$3431	\$4005
<input type="checkbox"/> 42w x 22d x ____h	\$4029	\$4747
<input type="checkbox"/> 48w x 22d x ____h	\$4029	\$4747
<input type="checkbox"/> 54w x 22d x ____h	\$4029	\$4747
Height Upcharge		
Up to 40"	40" - 60"	60" - 80"
No Charge	+ \$580	+ \$920

Finishes	
	Write Desired Finish Below
Base	
Banding	
Please see page 21 for available finishes	
Liner	
Hood Liner (fan) provided by Customer Please provide make, model & spec sheet	<input type="checkbox"/>
Hood Liner (fan) provided by Stoll Please contact Stoll for custom quote	<input type="checkbox"/>

ST1410S



*Includes Banding and Modern Rivets as shown

Pricing		
Size	Standard	Premium
<input type="checkbox"/> 36w x 22d x ____h	\$3374	\$3948
<input type="checkbox"/> 42w x 22d x ____h	\$3899	\$4618
<input type="checkbox"/> 48w x 22d x ____h	\$3899	\$4618
<input type="checkbox"/> 54w x 22d x ____h	\$3899	\$4618
Height Upcharge		
Up to 40"	40" - 60"	60" - 80"
No Charge	+ \$580	+ \$920

Finishes	
	Write Desired Finish Below
Base	
Banding	
Please see page 21 for available finishes	
Liner	
Hood Liner (fan) provided by Customer Please provide make, model & spec sheet	<input type="checkbox"/>
Hood Liner (fan) provided by Stoll Please contact Stoll for custom quote	<input type="checkbox"/>

Price	
Subtotal	\$
Total Price	\$

Dealer Information	
Dealer:	_____
Address:	_____
PO#:	_____
Name:	_____



Range Hood | ST1100

4-6 week production time

Pre-designed Style Options

Choose from one of the styles below, or create your own custom design

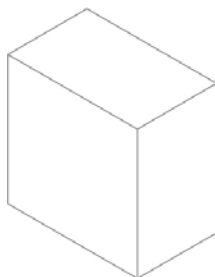

☐ ST1101



☐ ST1102*

*Must include Stacked Accent Kit upcharge

Sketch Pad

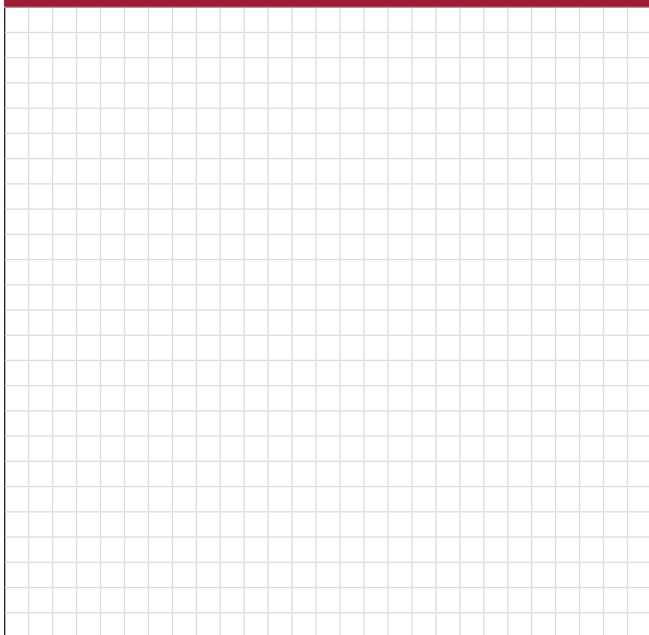

*If applicable, please use the sketch pad above to draw your custom design

Dimensions

W: _____ D: _____ H: _____

Important! Accent and banding material are not included in finished dimensions unless specified otherwise.

Base Pricing

based on finished width, up to 40" high

*Sizes over 60" w must include vertical banding to hide seams

Style	Up to 36" w	Up to 54" w	Up to 72" w	Up to 96" w
ST1100	<input type="checkbox"/> \$1582	<input type="checkbox"/> \$1979	<input type="checkbox"/> \$2372	<input type="checkbox"/> \$3163
Up to 60" high	+ \$665			
Up to 80" high	+ \$1065			

Over 80" high contact Stoll for quote

Hood Finish Upcharges

Finishes	Up to 36"	Up to 54"	Up to 72"	Up to 96"
Premium	<input type="checkbox"/> \$660	<input type="checkbox"/> \$880	<input type="checkbox"/> \$1100	<input type="checkbox"/> \$1650
Stainless	<input type="checkbox"/> \$2310	<input type="checkbox"/> \$3895	<input type="checkbox"/> \$5345	<input type="checkbox"/> \$6665
Solid	Call for quote & availability			
Outdoor	Call for quote & availability			

Finishes

Please see page 21 for available finishes

Body:

Banding & Rivets (if applicable):

Accent Kits

Stacked Accent Kit
*Includes choice of banding color

☐ \$1320

Banding

Pricing is per section of banding (Top, bottom, etc)

	Price	Qty
Vertical Banding	<input type="checkbox"/> \$220	
Horizontal Banding wraps the face and sides	<input type="checkbox"/> \$440	

Rivets

Rustic Rivets	<input type="checkbox"/> \$255
Modern Rivets	<input type="checkbox"/> \$255

Hood Liner (fan)

Hood Liner (fan) provided by Customer

☐

Please provide liner make & specs above

Hood Liner (fan) provided by Stoll
Please contact Stoll for custom quote

☐

Recessed Liner Kit

☐ \$255

Removable Access Panel

Includes vertical banding & modern rivets

☐ \$635

Price

Subtotal	\$
Total Price	\$

*Blue selections are the default and will be used if not specified differently

Dealer Information

Dealer: _____

Address: _____

PO#: _____ Name: _____



Range Hood | ST1200

4-6 week production time

Pre-designed Style Options

Choose from one of the styles below, or create your own custom design

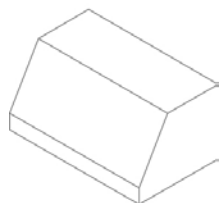

☐ ST1201

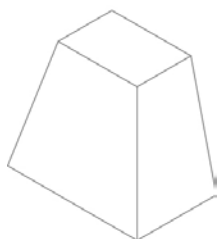

☐ ST1202

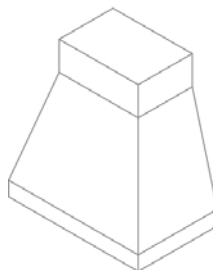

☐ ST1203

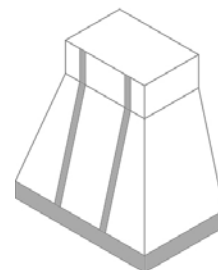

☐ ST1204*

**Must include appropriate banding upcharges*

Sketch Pad

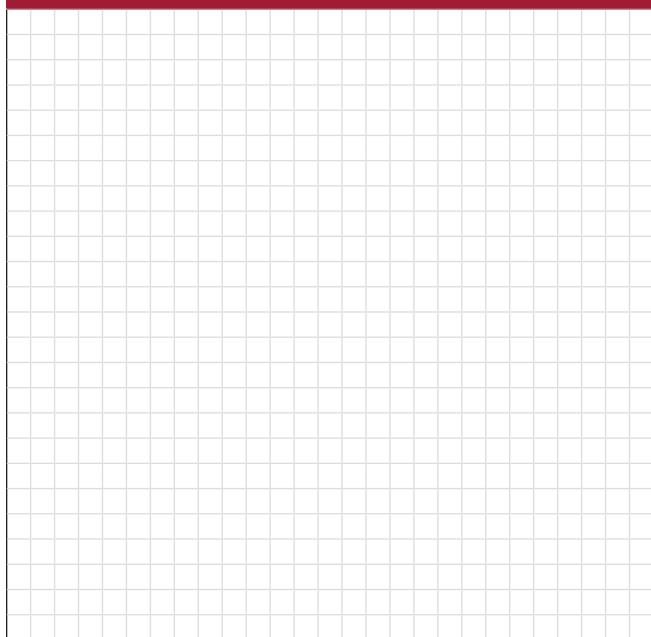

*If applicable, please use the sketch pad above to draw your custom design

Dimensions

W: _____ D: _____ H: _____

Important! Accent and banding material are not included in finished dimensions unless specified otherwise.

Base Pricing

based on finished width, up to 40" high

*Sizes over 60" w must include vertical banding to hide seams

Style	Up to 36" w	Up to 54" w	Up to 72" w	Up to 96" w
ST1200	<input type="checkbox"/> \$1883	<input type="checkbox"/> \$2354	<input type="checkbox"/> \$2823	<input type="checkbox"/> \$3764
Up to 60" high	+ \$665			
Up to 80" high	+ \$1065			

Over 80" high contact Stoll for quote

Hood Finish Upcharges

Finishes	Up to 36"	Up to 54"	Up to 72"	Up to 96"
Premium	<input type="checkbox"/> \$660	<input type="checkbox"/> \$880	<input type="checkbox"/> \$1100	<input type="checkbox"/> \$1650
Stainless	<input type="checkbox"/> \$2310	<input type="checkbox"/> \$3895	<input type="checkbox"/> \$5345	<input type="checkbox"/> \$6665
Solid	Call for quote & availability			
Outdoor	Call for quote & availability			

Finishes

Please see page 21 for available finishes

Body:

Banding & Rivets (if applicable):

Accent Kits

Finish availability may vary

Transitional Metal or Wood insert	<input type="checkbox"/> Metal* <input type="checkbox"/> Engadina <input type="checkbox"/> Salon <input type="checkbox"/> Espresso	\$990
Embossed Top	<input type="checkbox"/> Square <input type="checkbox"/> Angled	\$990
Embossed Bottom	<input type="checkbox"/> Square <input type="checkbox"/> Angled	\$990
Crown Molding	<input type="checkbox"/>	\$2850

Banding

Pricing is per section of banding (Top, bottom, etc)

	Price	Qty
Vertical Banding	<input type="checkbox"/> \$220	
Horizontal Banding wraps the face and sides	<input type="checkbox"/> \$440	

Rivets

Rustic Rivets	<input type="checkbox"/> \$255
Modern Rivets	<input type="checkbox"/> \$255

Hood Liner (fan)

Hood Liner (fan) provided by Customer	<input type="checkbox"/>
Please provide liner make & specs above	
Hood Liner (fan) provided by Stoll	<input type="checkbox"/>
Please contact Stoll for custom quote	
Recessed Liner Kit	<input type="checkbox"/> \$255
Removable Access Panel	<input type="checkbox"/> \$635
Includes vertical banding & modern rivets	

Price

Subtotal	\$
Total Price	\$

*Blue selections are the default and will be used if not specified differently

Dealer Information

Dealer: _____
 Address: _____
 PO#: _____ Name: _____



Range Hood | ST1300

4-6 week production time

Pre-designed Style Options

Choose from one of the styles below, or create your own custom design

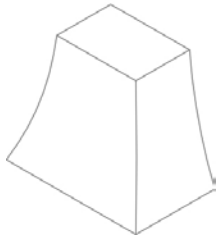

☐ ST1301

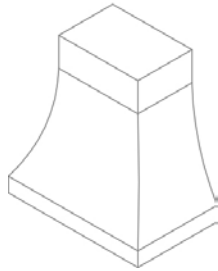

☐ ST1302

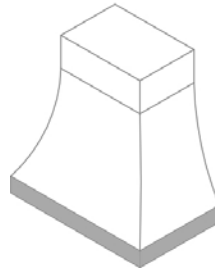

☐ ST1303*

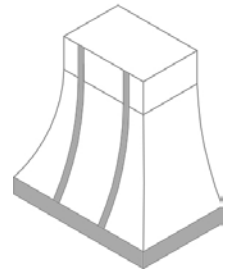

☐ ST1304*

*Must include appropriate banding upcharges

Sketch Pad

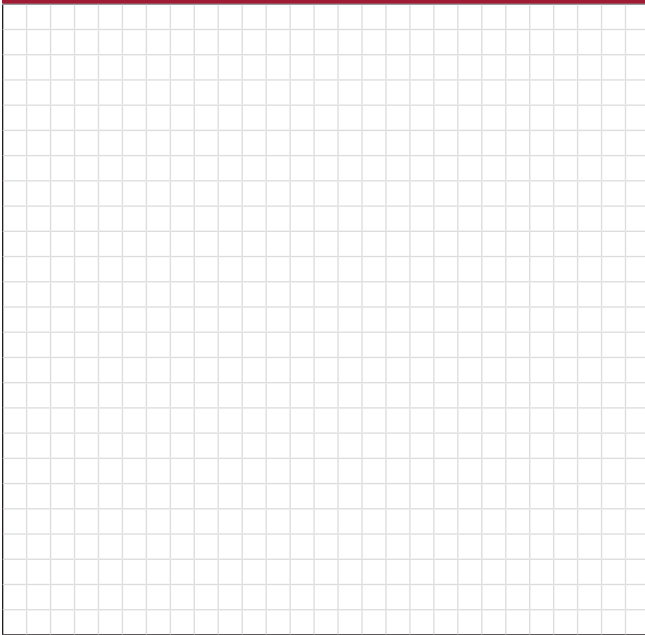

*If applicable, please use the sketch pad above to draw your custom design

Dimensions

W: _____ D: _____ H: _____

Important! Accent and banding material are not included in finished dimensions unless specified otherwise.

Base Pricing

based on finished width, up to 40" high

*Sizes over 60" w must include vertical banding to hide seams

Style	Up to 36" w	Up to 54" w	Up to 72" w	Up to 96" w
ST1300	<input type="checkbox"/> \$2769	<input type="checkbox"/> \$3461	<input type="checkbox"/> \$4152	<input type="checkbox"/> \$5535
Up to 60" high	+ \$665			
Up to 80" high	+ \$1065			

Over 80" high contact Stoll for quote

Hood Finish Upcharges

Finishes	Up to 36"	Up to 54"	Up to 72"	Up to 96"
Premium	<input type="checkbox"/> \$660	<input type="checkbox"/> \$880	<input type="checkbox"/> \$1100	<input type="checkbox"/> \$1650
Stainless	<input type="checkbox"/> \$2310	<input type="checkbox"/> \$3895	<input type="checkbox"/> \$5345	<input type="checkbox"/> \$6665
Solid	Call for quote & availability			
Outdoor	Call for quote & availability			

Finishes

Please see page 21 for available finishes

Body:

Banding & Rivets (if applicable):

Accent Kits

Finish availability may vary

Transitional Metal or Wood insert	<input type="checkbox"/> Metal* <input type="checkbox"/> Engadina <input type="checkbox"/> Salon <input type="checkbox"/> Espresso	\$990
Embossed Top	<input type="checkbox"/> Square <input type="checkbox"/> Angled	\$990
Embossed Bottom	<input type="checkbox"/> Square <input type="checkbox"/> Angled	\$990
Crown Molding	<input type="checkbox"/>	\$2850

Banding

Pricing is per section of banding (Top, bottom, etc)

	Price	Qty
Vertical Banding	<input type="checkbox"/> \$220	
Horizontal Banding wraps the face and sides	<input type="checkbox"/> \$440	

Rivets

Rustic Rivets	<input type="checkbox"/> \$255
Modern Rivets	<input type="checkbox"/> \$255

Hood Liner (fan)

Hood Liner (fan) provided by Customer	<input type="checkbox"/>
Please provide liner make & specs above	
Hood Liner (fan) provided by Stoll Please contact Stoll for custom quote	<input type="checkbox"/>
Recessed Liner Kit	<input type="checkbox"/> \$255
Removable Access Panel Includes vertical banding & modern rivets	<input type="checkbox"/> \$635

Price

*Blue selections are the default and will be used if not specified differently

Subtotal	\$
Total Price	\$

Dealer Information

Dealer: _____
Address: _____
PO#: _____ Name: _____



Range Hood | ST1400

4-6 week production time

Pre-designed Style Options

Choose from one of the styles below, or create your own custom design

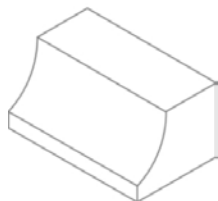

☐ ST1401

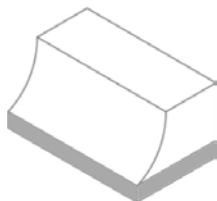

☐ ST1402*

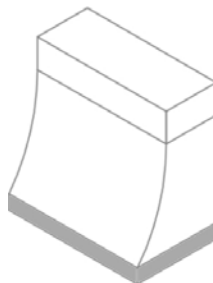

☐ ST1403*

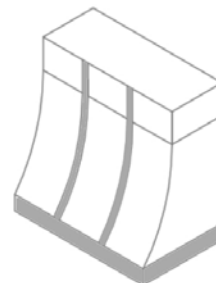

☐ ST1404*

**Must include appropriate banding upcharges*

Sketch Pad

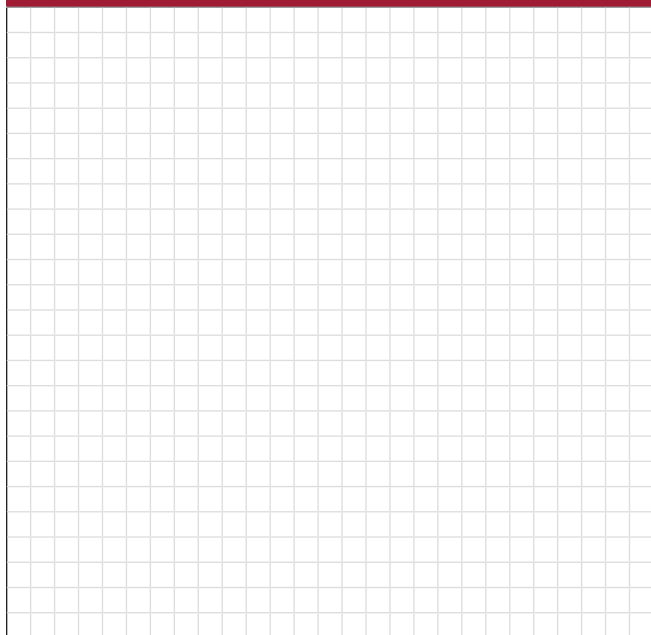

*If applicable, please use the sketch pad above to draw your custom design

Dimensions

W: _____ D: _____ H: _____

Important! Accent and banding material are not included in finished dimensions unless specified otherwise.

Base Pricing

based on finished width, up to 40" high

*Sizes over 60" w must include vertical banding to hide seams

Style	Up to 36" w	Up to 54" w	Up to 72" w	Up to 96" w
ST1400	<input type="checkbox"/> \$2437	<input type="checkbox"/> \$3045	<input type="checkbox"/> \$3653	<input type="checkbox"/> \$4871
Up to 60" high	+ \$665			
Up to 80" high	+ \$1065			

Over 80" high contact Stoll for quote

Hood Finish Upcharges

Finishes	Up to 36"	Up to 54"	Up to 72"	Up to 96"
Premium	<input type="checkbox"/> \$660	<input type="checkbox"/> \$880	<input type="checkbox"/> \$1100	<input type="checkbox"/> \$1650
Stainless	<input type="checkbox"/> \$2310	<input type="checkbox"/> \$3895	<input type="checkbox"/> \$5345	<input type="checkbox"/> \$6665
Solid	Call for quote & availability			
Outdoor	Call for quote & availability			

Finishes

Please see page 21 for available finishes

Body:

Banding & Rivets (if applicable):

Accent Kits

Finish availability may vary

Transitional Metal or Wood insert	<input type="checkbox"/> Metal* <input type="checkbox"/> Engadina <input type="checkbox"/> Salon <input type="checkbox"/> Espresso	\$990
Embossed Top	<input type="checkbox"/> Square <input type="checkbox"/> Angled	\$990
Embossed Bottom	<input type="checkbox"/> Square <input type="checkbox"/> Angled	\$990
Crown Molding	<input type="checkbox"/>	\$2850

Banding

Pricing is per section of banding (Top, bottom, etc)

	Price	Qty
Vertical Banding	<input type="checkbox"/> \$220	
Horizontal Banding wraps the face and sides	<input type="checkbox"/> \$440	

Rivets

Rustic Rivets	<input type="checkbox"/> \$255
Modern Rivets	<input type="checkbox"/> \$255

Hood Liner (fan)

Hood Liner (fan) provided by Customer	<input type="checkbox"/>
Please provide liner make & specs above	
Hood Liner (fan) provided by Stoll	<input type="checkbox"/>
Please contact Stoll for custom quote	
Recessed Liner Kit	<input type="checkbox"/> \$255
Removable Access Panel	<input type="checkbox"/> \$635
Includes vertical banding & modern rivets	

Price

*Blue selections are the default and will be used if not specified differently

Subtotal	\$
Total Price	\$

Dealer Information

Dealer: _____

Address: _____

PO#: _____ Name: _____



Range Hood | ST1500

4-6 week production time

Pre-designed Style Options

Choose from one of the styles below, or create your own custom design

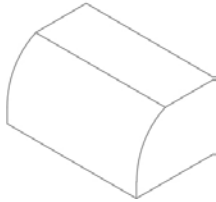

☐ ST1501

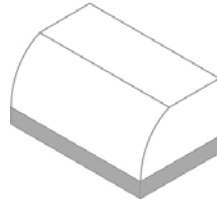

☐ ST1502*

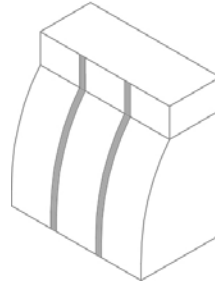

☐ ST1503*

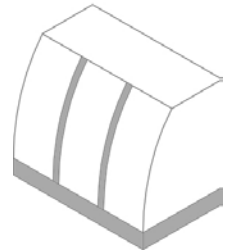

☐ ST1504*

**Must include appropriate banding upcharges*

Sketch Pad

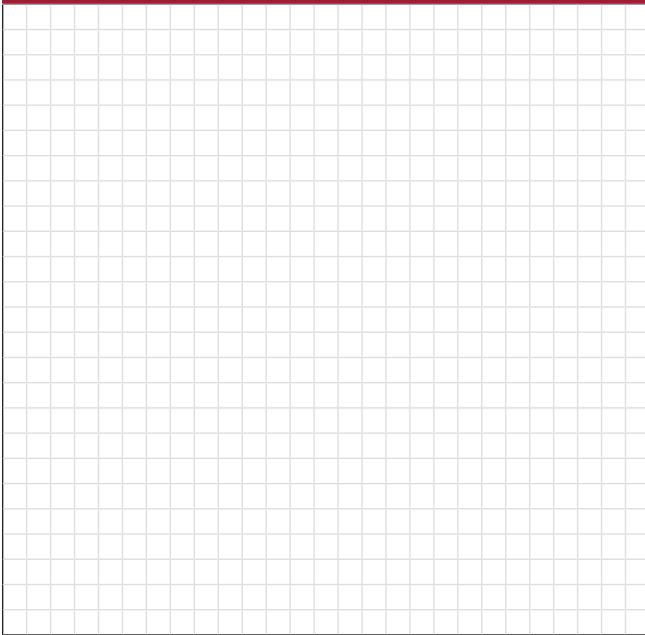

*If applicable, please use the sketch pad above to draw your custom design

Dimensions

W: _____ D: _____ H: _____

Important! Accent and banding material are not included in finished dimensions unless specified otherwise.

Base Pricing

based on finished width, up to 40" high

*Sizes over 60" w must include vertical banding to hide seams

Style	Up to 36" w	Up to 54" w	Up to 72" w	Up to 96" w
ST1500	<input type="checkbox"/> \$2437	<input type="checkbox"/> \$3045	<input type="checkbox"/> \$3653	<input type="checkbox"/> \$4871
Up to 60" high	+ \$665			
Up to 80" high	+ \$1065			

Over 80" high contact Stoll for quote

Hood Finish Upcharges

Finishes	Up to 36"	Up to 54"	Up to 72"	Up to 96"
Premium	<input type="checkbox"/> \$660	<input type="checkbox"/> \$880	<input type="checkbox"/> \$1100	<input type="checkbox"/> \$1650
Stainless	<input type="checkbox"/> \$2310	<input type="checkbox"/> \$3895	<input type="checkbox"/> \$5345	<input type="checkbox"/> \$6665
Solid	Call for quote & availability			
Outdoor	Call for quote & availability			

Finishes

Please see page 21 for available finishes

Body:

Banding & Rivets (if applicable):

Accent Kits

Finish availability may vary

Transitional Metal or Wood insert	<input type="checkbox"/> Metal* <input type="checkbox"/> Engadina <input type="checkbox"/> Salon <input type="checkbox"/> Espresso	\$990
Embossed Top	<input type="checkbox"/> Square <input type="checkbox"/> Angled	\$990
Embossed Bottom	<input type="checkbox"/> Square <input type="checkbox"/> Angled	\$990
Crown Molding	<input type="checkbox"/>	\$2850

Banding

Pricing is per section of banding (Top, bottom, etc)

	Price	Qty
Vertical Banding	<input type="checkbox"/> \$220	
Horizontal Banding wraps the face and sides	<input type="checkbox"/> \$440	

Rivets

Rustic Rivets	<input type="checkbox"/> \$255
Modern Rivets	<input type="checkbox"/> \$255

Hood Liner (fan)

Hood Liner (fan) provided by Customer	<input type="checkbox"/>
Please provide liner make & specs above	
Hood Liner (fan) provided by Stoll Please contact Stoll for custom quote	<input type="checkbox"/>
Recessed Liner Kit	<input type="checkbox"/> \$255
Removable Access Panel Includes vertical banding & modern rivets	<input type="checkbox"/> \$635

Price

Subtotal	\$
Total Price	\$

*Blue selections are the default and will be used if not specified differently

Dealer Information

Dealer: _____
 Address: _____
 PO#: _____ Name: _____



Countertop | Custom Order Form

Sketch Pad

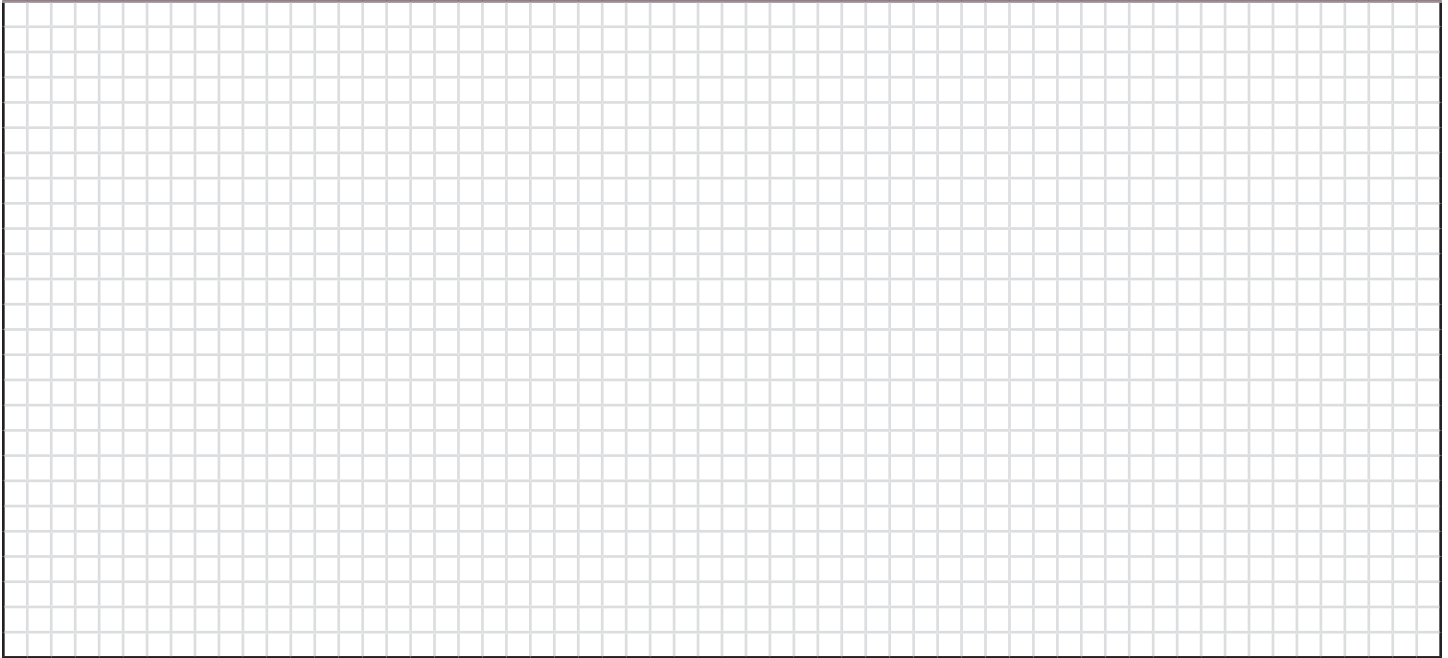

Please use the sketch pad above to draw the desired shape of your countertop, including any special cutouts, angles, or openings. Please include the necessary measurements where needed.

Pricing

Price per Square Ft:

Standard Finishes: \$73 per sq/ft

Premium Finishes: \$89 per sq/ft

Stainless: \$106 per sq/ft

Lip/Exposed Edges

Choose which edges should have a finished lip.

☐ Front ☐ Back ☐ Left ☐ Right

Exposed Edge/Lip Height

☐ 1.5" ☐ 2.5" ☐ 4"

Backsplash

Backsplash Height *Optional, \$36 per linear foot

☒ None* ☐ 4" ☐ 6" ☐ 8" ☐ 10"

Backerboard

☒ Non-Combustible Backerboard*

☐ Wooden Backerboard

☐ None

Finishes

Write Desired Finishes Below

Countertop

Powdercoats - All Except Clear Natural

Premium - All

Stainless - Brushed or Non-Directional

Examples

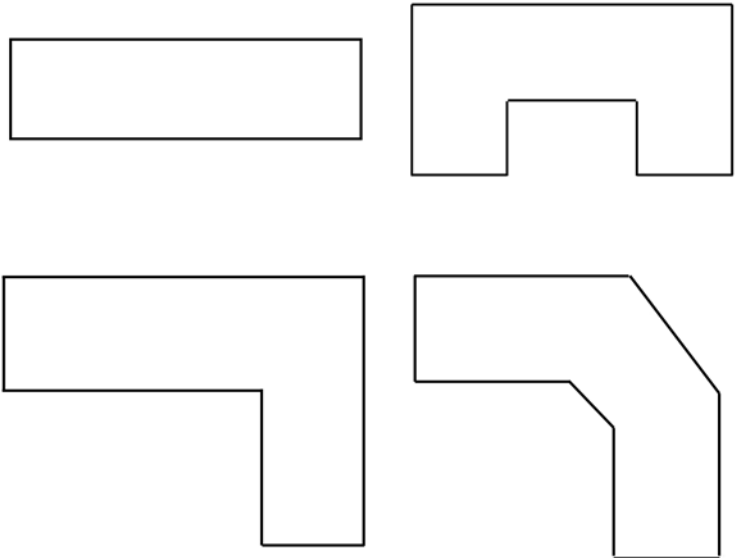

Price

Subtotal	\$
Total Price	\$

*Blue selections are the default and will be used if not specified differently

Dealer Info

Dealer		
Address		
City	State	Zip
PO/Customer		



SHELF | CUSTOM & STANDARD SIZES

15 business day production time
Stainless Steel 4-6 weeks production time

STANDARD SIZES			
WIDTH	HEIGHT	DEPTH	PRICE
<input type="checkbox"/> 24"	<input type="checkbox"/> 3" <input type="checkbox"/> 4"	6"	\$327
<input type="checkbox"/> 36"	<input type="checkbox"/> 3" <input type="checkbox"/> 4"	6"	\$383
<input type="checkbox"/> 48"	<input type="checkbox"/> 3" <input type="checkbox"/> 4"	8"	\$506
<input type="checkbox"/> 58"	<input type="checkbox"/> 3" <input type="checkbox"/> 4"	8"	\$506
<input type="checkbox"/> 72"	<input type="checkbox"/> 3" <input type="checkbox"/> 4"	8"	\$534
<input type="checkbox"/> 84"	<input type="checkbox"/> 3" <input type="checkbox"/> 4"	8"	\$561

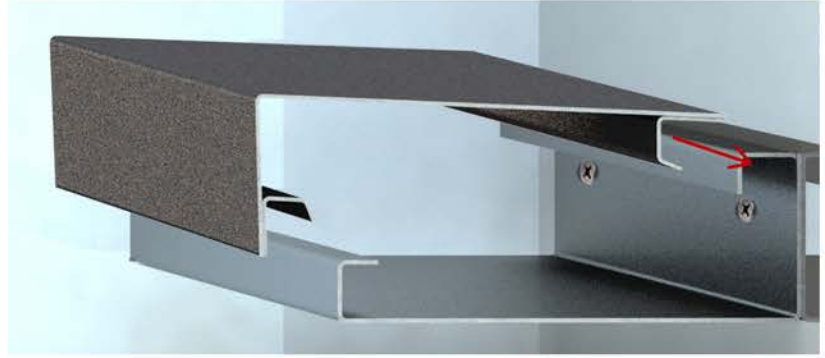

CUSTOM SIZES				
	WIDTH	HEIGHT	DEPTH	
Up to 30"	_____	<input type="checkbox"/> 2" <input type="checkbox"/> 3" <input type="checkbox"/> 4" <input type="checkbox"/> 5"	<input type="checkbox"/> 5" <input type="checkbox"/> 6" <input type="checkbox"/> 8" <input type="checkbox"/> 10"	\$447
Up to 50"	_____	<input type="checkbox"/> 2" <input type="checkbox"/> 3" <input type="checkbox"/> 4" <input type="checkbox"/> 5"	<input type="checkbox"/> 6" <input type="checkbox"/> 8" <input type="checkbox"/> 10" <input type="checkbox"/> 12"	\$582
Up to 70"	_____	<input type="checkbox"/> 2" <input type="checkbox"/> 3" <input type="checkbox"/> 4" <input type="checkbox"/> 5"	<input type="checkbox"/> 6" <input type="checkbox"/> 8" <input type="checkbox"/> 10" <input type="checkbox"/> 12"	\$703
Up to 90"	_____	<input type="checkbox"/> 2" <input type="checkbox"/> 3" <input type="checkbox"/> 4" <input type="checkbox"/> 5"	<input type="checkbox"/> 6" <input type="checkbox"/> 8" <input type="checkbox"/> 10" <input type="checkbox"/> 12"	\$844
Up to 110"	_____	<input type="checkbox"/> 2" <input type="checkbox"/> 3" <input type="checkbox"/> 4" <input type="checkbox"/> 5"	<input type="checkbox"/> 6" <input type="checkbox"/> 8" <input type="checkbox"/> 10" <input type="checkbox"/> 12"	\$987
Over 110": Contact for Quote				
Add \$125 per 2" increase over height and depth dimensions above, custom sizes only				

FINISH SELECTION	
Aspire Rust	<input type="checkbox"/>
Bronzed Iron	<input type="checkbox"/>
Champagne	<input type="checkbox"/>
Charcoal	<input type="checkbox"/>
Concrete	<input type="checkbox"/>
Copper Vein	<input type="checkbox"/>
Matte Black	<input type="checkbox"/>
Oil Rubbed Bronze	<input type="checkbox"/>
Silver Mist	<input type="checkbox"/>
Silver Vein	<input type="checkbox"/>
Textured Black	<input type="checkbox"/>
Vintage Vein	<input type="checkbox"/>
White	<input type="checkbox"/>

PREMIUM POWDERCOAT	
Antique Black	<input type="checkbox"/> \$300
Antique Bronze	<input type="checkbox"/> \$300
Antique Grey	<input type="checkbox"/> \$300
Antique Red	<input type="checkbox"/> \$300
Antique Steel	<input type="checkbox"/> \$300
Brushed Black	<input type="checkbox"/> \$300
Brushed White	<input type="checkbox"/> \$300
Burnished Bronze	<input type="checkbox"/> \$300
Burnished Copper	<input type="checkbox"/> \$300
Hale Navy	<input type="checkbox"/> \$300
Industrial Black	<input type="checkbox"/> \$300
Metallic Latte	<input type="checkbox"/> \$300
Natural Iron	<input type="checkbox"/> \$300
Satin Gold	<input type="checkbox"/> \$300

STAINLESS STEEL CUSTOM SIZES ONLY	
Stainless Steel	<input type="checkbox"/> \$600

SHELF OPTIONS

- ☐ Aged Iron Banding.....\$360
- ☐ Blacksmith Banding.....\$125
- ☐ Industrial Support Brackets.....\$185
- ☐ Old World Banding.....\$125
- ☐ Square Support Brackets.....\$185
- ☐ Transitional Style *Includes Old World Banding*\$399
- Wood Insert*: ☐ Engadina ☐ Espresso ☐ Salon
- *Wood insert is combustible*
- ☐ Corner Shelf (send diagram)
.....Price each return as separate shelf + \$125
- ☐ Bluetooth Speakers and LED Lights*\$530
- *4" Minimum height needed*
- ☐ LED Lights.....\$185
- ☐ Keylock.....\$185

WOOD GRAIN SHELF

Add upcharge to regular price on sizing chart

- ☐ Non-Combustible Wood Grain Shelf*
- *Bottom of shelf will be Matte Black unless bottom option chosen below*
- Quickship: 58x4 and 72x4 1-2 weeks.....\$599 upcharge
- All Other Standard & Custom Sizes 6-8 weeks.....\$900 upcharge
- ☐ Add Woodgrain to bottom of shelf 6-8 weeks.....\$499 upcharge

ADDITIONAL INSTRUCTIONS

TOTAL RETAIL PRICE:
\$

*Blue selection is default choice and will be used if not specified differently.

Dealer Name: _____

Address: _____

Salesperson: _____

Phone: _____

PO#: _____

Name: _____

WALL PANEL SYSTEMS

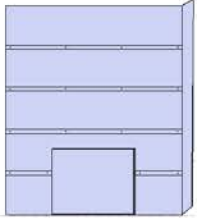
Description		Steel Walls	
Custom sized steel panels		<ul style="list-style-type: none"> •Panel widths up to 119" •Panel height is customizable, and varies by style •Available with Banding and/or Rivets •Depth: 1/8" Panels + Mounting System 	
Frame Specs			
Material	11 Gauge Steel or 304 Stainless		
Mounting	Interlock or Standard mounting system		

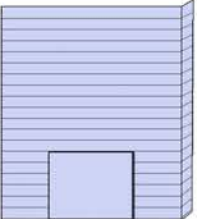
Description		Aluminum Shiplap Wall	
A non-combustible aluminum wall providing a wooden shiplap appearance.		<ul style="list-style-type: none"> • Panel widths up to 120" • Panels are 5" tall each • Depth: 3/8" 	
Frame Specs			
Material	5" Aluminum Panels		
Mounting	Built in Mounting System		

Mounting Systems			
Interlock Mounting System		Standard Mounting System	
Panels are formed with an integrated cleat system that does not require additional tracks for installation. Each panel locks into the panel below, and is fastened at the top using appropriate fasteners. Adjustable magnetic trims finish out the perimeter to complete the space.		Panels are equipped with welded friction tabs on the back that lock into an aluminum track system. Each track is fastened using appropriate fasteners. Adjustable magnetic trims finish out the perimeter to complete the space.	
Depth	3/4"	Depth	7/8"

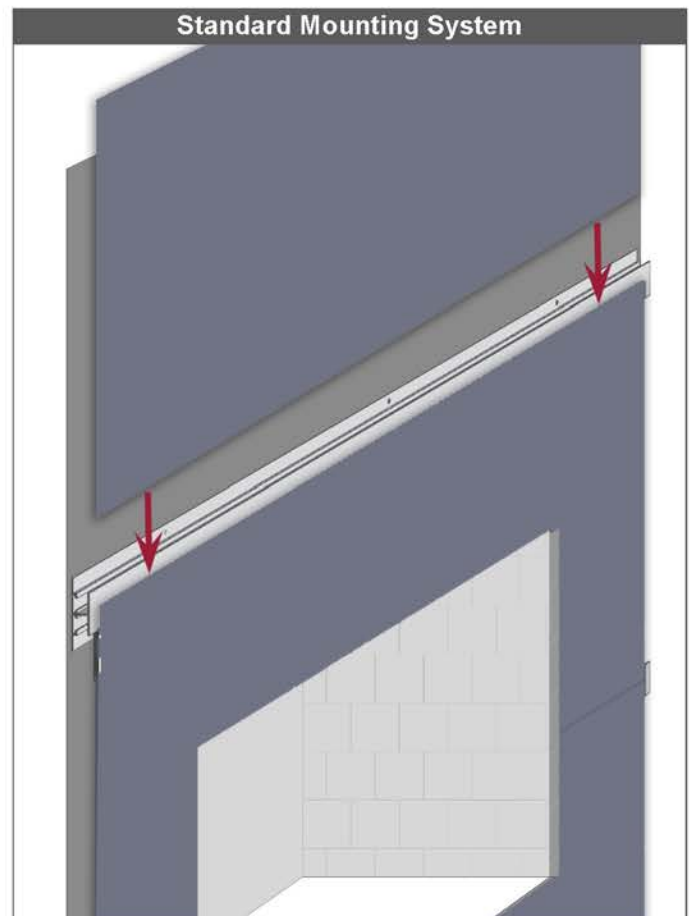
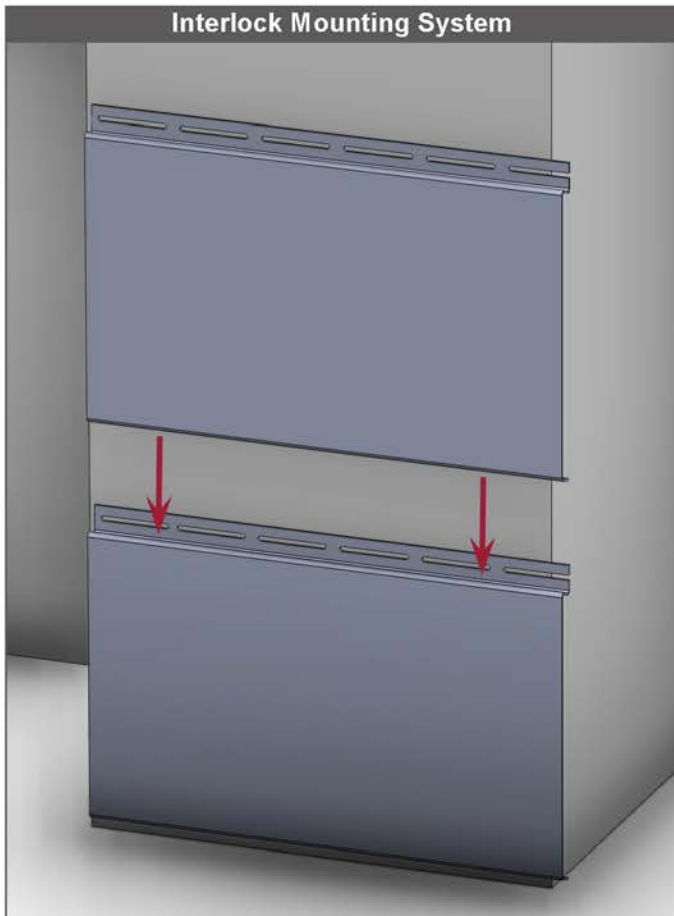



WALL PANEL SYSTEMS

4 week production time

Wall Styles

Steel

Choose Style Below
All styles include mounting

Minimum Price \$1000

Interlock Panel Mounting

- ☐ Horizontal.....\$50 sq/ft
- ☐ Vertical\$50 sq/ft
- ☐ Tile\$50 sq/ft
- ☐ Squares\$50 sq/ft
- ☐ Metal Plank\$50 sq/ft
- ☐ Board & Batten.....\$60 sq/ft

Standard Panel Mounting

- ☐ Horizontal.....\$65 sq/ft
- ☐ Vertical\$65 sq/ft
- ☐ Tile\$65 sq/ft
- ☐ Squares\$65 sq/ft
- ☐ Dimensional.....\$65 sq/ft

Decorative Options

- ☐ Banding: \$7 sq/ft
Min. Price \$140
- ☐ Rustic Rivets: \$5 sq/ft
Min. Price \$100
- ☐ Modern Rivets: \$5 sq/ft
Min. Price \$100

Stainless

Choose Style Below
All styles include mounting

Minimum Price \$1360

Standard Panel Mounting

- ☐ Horizontal.....\$90 sq/ft
- ☐ Vertical\$90 sq/ft
- ☐ Tile\$90 sq/ft
- ☐ 4 Panel\$90 sq/ft
- ☐ Metal Plank\$90 sq/ft

Decorative Options

- ☐ Banding: \$7 sq/ft
Min. Price \$140

Aluminum Shiplap

Includes built-in mounting system

- ☐ Shiplap.....\$46 sq/ft
Minimum Price \$840

WALL DIMENSIONS

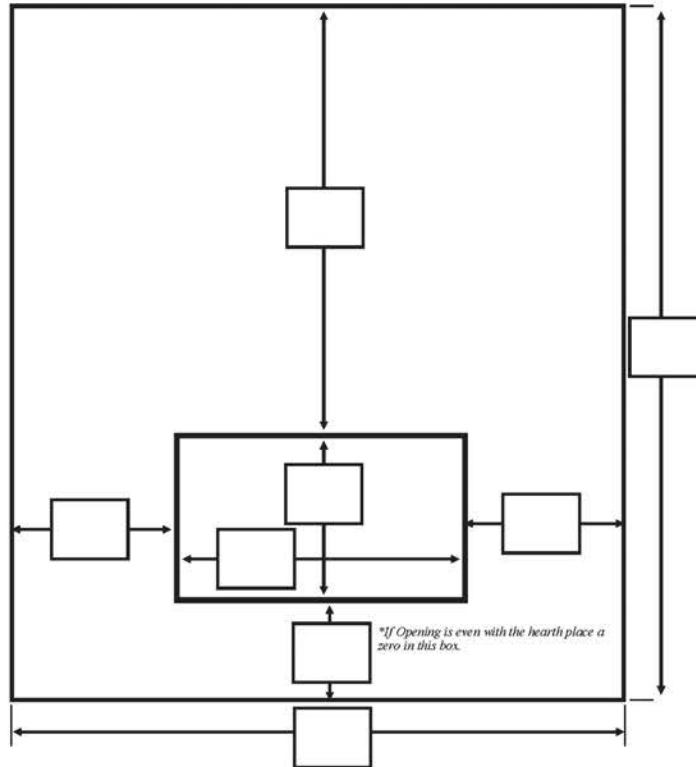

FINISH SELECTION

FINISH

Aspire Rust	<input type="checkbox"/>
Bronzed Iron	<input type="checkbox"/>
Champagne	<input type="checkbox"/>
Charcoal	<input type="checkbox"/>
Concrete	<input type="checkbox"/>
Copper Vein	<input type="checkbox"/>
Matte Black	<input type="checkbox"/>
Oil Rubbed Bronze	<input type="checkbox"/>
Silver Mist	<input type="checkbox"/>
Silver Vein	<input type="checkbox"/>
Textured Black	<input type="checkbox"/>
Vintage Vein	<input type="checkbox"/>
White	<input type="checkbox"/>

PREMIUM POWDERCOAT

Minimum 8 sq/ft charge

Antique Black	<input type="checkbox"/> \$22 sq/ft
Antique Bronze	<input type="checkbox"/> \$22 sq/ft
Antique Grey	<input type="checkbox"/> \$22 sq/ft
Antique Red	<input type="checkbox"/> \$22 sq/ft
Antique Steel	<input type="checkbox"/> \$22 sq/ft
Brushed Black	<input type="checkbox"/> \$22 sq/ft
Brushed White	<input type="checkbox"/> \$22 sq/ft
Burnished Bronze	<input type="checkbox"/> \$22 sq/ft
Burnished Copper	<input type="checkbox"/> \$22 sq/ft
Hale Navy	<input type="checkbox"/> \$22 sq/ft
Industrial Black	<input type="checkbox"/> \$22 sq/ft
Metallic Latte	<input type="checkbox"/> \$22 sq/ft
Natural Iron	<input type="checkbox"/> \$22 sq/ft
Satin Gold	<input type="checkbox"/> \$22 sq/ft

WALL PANEL RETURNS* (price by sq/ft see prices above)

*Attach images as needed	Depth of Return
Left Side Return: <input type="checkbox"/> None* <input type="checkbox"/> Forward Facing <input type="checkbox"/> Rear Facing	
Right Side Return: <input type="checkbox"/> None* <input type="checkbox"/> Forward Facing <input type="checkbox"/> Rear Facing	

TRIM

- ☐ Standard Trim* ☐ Post Trim \$25/Li Ft

TOTAL RETAIL PRICE:
\$

*Blue selection is default choice and will be used if not specified differently.

Dealer: _____

Address: _____

PO#: _____ Name: _____



DISPLAY & POS

Literature

Minimal shipping fees will apply to all orders

	Size/Details	Cost	Qty
Kitchen & Bath Orderbook		-	_____
Outdoor Living Orderbook		-	_____
Kitchen & Bath Brochure		-	_____
Outdoor Living Brochure		-	_____
Wall & Shelf Brochure		-	_____

Samples

Minimal shipping fees will apply to all orders

Powdercoat Finishes		-	_____
Premium Finishes		-	_____
Solid/Plated Finishes	<i>Subject to availability</i>	\$25	_____
12" x 12" Finish Samples (each)	12" x 12"	\$15	_____
<i>Please attach list of desired Finishes</i>			
Transitional Wood Sample Set	4" x 4"	\$30	_____
Shiplap Sample		-	_____
Woodgrain Shelf Color Sample		-	_____
Cabinet Glass Premium Sample	12" x 12"	\$25	_____
Cabinet Mesh Premium Sample	12" x 12"	\$25	_____

Display Stands & Signage

Cabinet & Hood Tower	20"W x 20"D x 57"H	\$2250	_____
Wall Panel Display Board	24"W x 20"H	\$150	_____
3 Piece Mantel Shelf Display	18"W x 12"D X 35"H	\$300	_____
Authorized Dealer Sign	7"H x 39"W	\$50	_____

Product Displays

Kitchen & Bath Products	65% off retail price
Walls Systems & Shelves	65% off retail price
Outdoor Kitchens, Islands, & Carts	65% off retail price
Outdoor Fire Tables	Cash & Carry, normal discount applies

Cabinet & Hood Tower



Side A



Side B



DEALER PORTAL

We highly recommend accessing our free dealer portal which offers many helpful tools for our dealers! Our Status Check feature is a powerful tool that lets you see the live production status of each order in our system, as well as provide tracking and shipment information for orders that have shipped. Download brochures, pricebooks, and interactive order forms to increase your order accuracy. New signage and POS items have also been added that are only available through the portal!

Show **25** entries

Search:

Invoice	Description	PO/NO	Shipping Via	Est. Ship Date	Tracking
+	Old World Design\Arch	CAINS JOB		2021-05-25	
+	Original Standard	RIEHLE	AAA Cooper	2021-04-18	196926992
+	ZC Reface	POOLE JOB		2021-05-13	
+	Original Standard	MERRELL	AAA Cooper	2021-04-18	196926992
+	Riser Bar in Charcoal for order #436719 .75"x37.3		AAA Cooper	2021-04-18	196926992
+	Premium Antique Color Samples		UPS Ground	2021-04-07	1Z2263680364701511
+	REPLACEMENT MESH	REID	UPS Ground	2021-04-05	1Z2263680373869600
+	Aluminum Outdoor Kitchen Base	DISPLAY	Southeastern	2021-04-18	675719844
+	Original Standard	RICHARD BARTON	AAA Cooper	2021-04-04	196926190
+	Return Authorization - Details & Changes Original	KALPAGIAN	AAA Cooper	2021-04-04	196926190
+	Return Authorization - Details & Changes Original	ZIDEK	AAA Cooper	2021-04-21	196926323
+	Columbia Bar Iron	LISA BADRAS	Southeastern	2021-03-24	675746434
+	Builder Plus Reface	GREEN	AAA Cooper	2021-04-21	196926323
+	Concrete Sample		UPS Ground	2021-03-22	1Z2263680364055845

If you forget your password, click “forgot password” on the login screen. If you don’t know your username, the email associated with the account, or if an account was ever set up, please click “need an account”, and we will reset your information or set up an account as needed.

Dealer Portal Login

Username or Email Address

Password

☐ Remember Me

Login

Need an Account or Forgot Username? | Forgot your password?



FINISHES

See order forms for pricing

Powdercoat Finishes



Aspire Rust



Bronzed Iron



Champagne

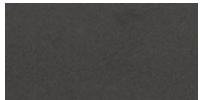

Charcoal



Concrete



Copper Vein



Matte Black



Oil Rubbed
Bronze



Silver Mist



Silver Vein



Textured Black



Vintage Vein



White

Premium Finishes



Antique Black



Antique Steel



Antique Bronze

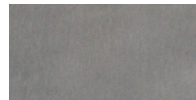

Antique Grey

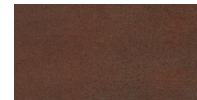

Antique Red

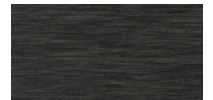

Brushed Black



Brushed White



Burnished Bronze



Burnished Copper



Hale Navy

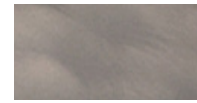

Industrial Black



Metallic Latte



Natural Iron



Satin Gold

Plated Finishes



Aged Copper



Aged Brass



Newport Brass



Brushed Stainless

Contact Information

Customer Service:

When calling Stoll during regular office hours you can expect to speak to customer service personnel without going through an answering machine. We also provide quick access to management level personnel whenever possible. Our goal is to offer you fast, accurate answers, efficient resolution to problems of any kind, and personal customer service. E-mail or Fax are available anytime.

Phone Support Hours:

Monday thru Thursday: 9:00 am to 4:30 pm EST

Company Address & Information:

Stoll Industries
153 Hwy 201
Abbeville, SC 29620
Website: www.stollindustries.com

Toll Free: (800) 421-0771
Phone: (864) 446-2171
Fax: (864) 446-2172
Email: design@stollindustries.com

Company Contacts:

Title
Quotes, Orders, & Support
Brochure/Sample Orders
Angie Chapman: <i>Accounting</i>

Email
design@stollindustries.com
reception@stollindustries.com
accounting@stollindustries.com



Stoll Industries
153 Hwy 201
Abbeville, SC 29620
800-421-0771
www.stollindustries.com

